

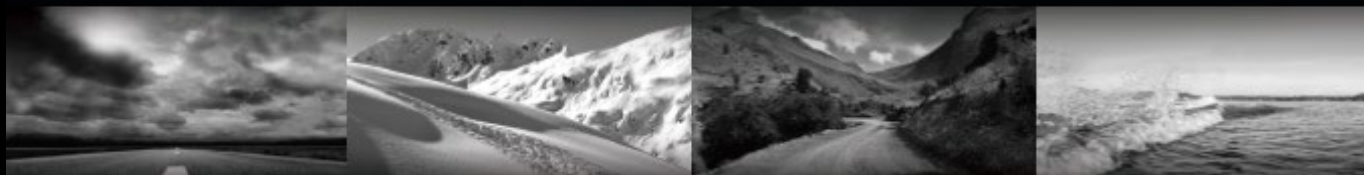

*ski-doo* *LYNX* *SEA-DOO* *ROTAX* *can-am*



# PYRA HELMET

## USER GUIDE

USER GUIDE

# PYRA

ENGLISH



# PYRA Helmet

## CONGRATULATIONS!

You now have in your possession our newly designed Pyra helmet. This MX style helmet has been engineered to not only keep you safe but also look great on the mountain, trails, or cross track. The lightweight technology, coupled with our new Energy Reduction Technology makes this one of our safest and most versatile helmets ever.

When you wear your Pyra you can feel secure knowing that this helmet has gone through rigorous testing and passed even the most advanced DOT and ECE certification. Provided with high airflow, the Pyra helmet is equipped with a removable wind deflector, making it an excellent 4 season helmet.

You can feel secure in the knowledge that you now own a quality helmet that is designed to provide you safety and high standards of performance in particular on long journeys – and that will give you a great deal of pleasure at the same time.

Please take the time to read through this manual carefully so that your helmet protects you properly when riding your snowmobile or motorcycle. To ensure that you do not overlook any aspect of the manual that is relevant to your safety, we recommend that you read it in the order in which it appears.

### **WARNING**

This helmet complies with U.S. Federal Motor Vehicle Safety Standard 218 (DOT FMVSS 218) and/or the United Nations Economic Commission for Europe Regulation 22 (ECE R22.06). This helmet was not designed to be used by a child under 13.

We wish you a safe ride.



# CONTENTS

<b>A. GENERAL .....</b>	<b>4</b>
1. SAFETY INFORMATION	4
<b>B. THE HELMET .....</b>	<b>5</b>
1. ANATOMY OF THE HELMET	5
2. HELMET SIZING	5
3. WIND DEFLECTOR	5
REMOVING / INSTALLING THE WIND DEFLECTOR	5
4. CHINSTRAP ATTACHEMENT	6
ADJUSTING THE CHINSTRAP	6
5. INNER LINER	6
REMOVING / INSTALLING THE CHEEK PADS	7
REMOVING / INSTALLING THE HEAD LINER	7
REMOVING / INSTALLING THE PEAK PIVOT	8
<b>C. FIT &amp; USAGE .....</b>	<b>9</b>
1. HOW TO PUT THE HELMET ON	9
2. PROPER FIT	9
1. MEASURE HEAD CIRCUMFERENCE	9
2. TRY ON THE HELMET	9
3. CHECK FOR A PROPER FIT	9
4. CHECK YOUR FIELD OF VISION	10
5. TEST THE HELMET FIT	10
6. FASTEN THE CHINSTRAP	10
7. TEST THE CHINSTRAP FIT	10
3. PUT THE HELMET OFF	10
4. PROPER USAGE	11
5. PROPER HELMET HANDLING	11

<b>D. BEFORE EVERY RIDE .....</b>	<b>12</b>
1. CHECKING THE HELMET	12
<b>E. OTHER IMPORTANT INFORMATION.....</b>	<b>13</b>
1. MODIFICATIONS / ACCESSORIES	13
2. FROSTBITE	13
<b>F. CARE AND MAINTENANCE .....</b>	<b>14</b>
1. SHELL CLEANING	14
2. INTERIOR CLEANING	14
3. HELMET INSPECTION	14
4. HELMET STORAGE	14
<b>G. TROUBLESHOOTING GUIDE .....</b>	<b>15</b>
<b>H. ACCESSORIES AND REPLACEMENT PARTS .....</b>	<b>15</b>
1. REPLACEMENT PARTS	15
<b>I. BRP SERVICE.....</b>	<b>16</b>
1. REPAIR SERVICE	16
2. WARRANTY	16
<b>J. HOW TO CONTACT US.....</b>	<b>16</b>

# A. GENERAL

## 1. SAFETY INFORMATION

This helmet is backed by the BRP warranty and a network of authorized dealers and distributors ready to provide the parts, service or accessories that you may require. Genuine BRP parts should be used for replacement to maintain the warranty, consult an authorized BRP dealer.

Use this User Guide to acquaint yourself with your new helmet and its various functions. Make sure you read and understand the contents of this guide and keep it for future reference. The information and components descriptions contained in this guide are accurate at time of publication. The illustrations in this document may not show the typical construction of the different assemblies or may not reproduce the full detail or exact shape of the parts shown, however, they represent parts which have the same or a similar function.

This guide uses the following safety alert symbol  in conjunction with signal words to indicate a potential personal injury hazard.

 <b>WARNING</b>
Indicates a hazardous situation which, if not avoided, could result in death or serious injury.

<b>NOTICE</b>
Address practices not related to personal injury.

Simply reading this guide will not eliminate hazards. The user must understand and follow the instructions. Because of its ongoing commitment to product quality and innovation, BRP reserves the right at any time to discontinue or change specifications, designs, features or equipment without incurring obligation. If anyone seeks to translate any portion of this guide into any language, this person must ensure that the translation is accurate.

## **WARNING**

Riding a motorized vehicle can be extremely dangerous. This helmet provides limited protection to the head. It complies with U.S. Federal Motor Vehicle Safety Standard 218 (DOT FMVSS 218) and/or the United Nations Economic Commission for Europe Regulation 22 (ECE R22.06).

However, it will not protect the wearer against all possible impacts. Some impacts may exceed this helmet's capability to provide protection and result in serious head, brain, spinal, or other injury including paralysis or death. For maximum protection, the helmet must fit firmly on the head with the chinstrap securely fastened.

If your helmet is equipped with a main visor, it must be fully closed. If your helmet is equipped with other component, such as wind deflector, breath deflector, breathing mask, mandible, etc., make sure to install them in proper position to direct exhaled breath away from the main visor. Always wear appropriate protection against frostbite, which may include a balaclava, neck tube, facemask or combination of these items.

Inspect the helmet before each use following the inspection procedure in the instructions. Replace any part showing wear or damage. Do not alter the helmet or attach any items not recommended by the manufacturer. The helmet is designed to absorb shock by partial destruction of the shell and it should not be visible. Destroy and replace helmet if subjected liner, which may not be visible. Destroy and replace helmet if subjected to a severe blow even if it appears undamaged.

The helmet shell, liner and other components may be damaged and rendered ineffective by petroleum products, cleaning agents, paint, adhesives, etc., without the damage being visible. Use only warm mild soapy water to clean the helmet.

Follow all warnings and instructions provided with this helmet. For replacement instructions, contact BRP. Failure to follow all warnings and instructions can result in serious personal injury or death.

## B. THE HELMET

### 1. ANATOMY OF THE HELMET



### 2. HELMET SIZING

Helmet size	XS	S	M	L	XL	2XL	3XL	
Shell size	S				L			
Head size	mm	53 - 54	55 - 56	57 - 58	59 - 60	61 - 62	63 - 64	65 - 66
	Inches	20 7/8 - 21 1/4	21 5/8 - 22	22 3/8 - 22 3/4	23 1/8 - 23 5/8	24 - 24 3/8	24 3/4 - 25 1/8	25 1/2 - 25 7/8

### 3. WIND DEFLECTOR

The wind deflector reduces air intrusion and unpleasant effect of the wind created when you ride by flowing into the helmet. This feature allows to also reduce the riding noises (such as wind, motor, track...). In addition, the wind deflector prevents the infiltration of several contaminants (such as rocks, snow, sand, ice, etc.)

For optimal performance of the helmet, it should be used with the BRP PYRA balaclava.

#### REMOVING THE WIND DEFLECTOR

1. Press the side of the wind deflector as shown to remove the bottom part.



2. Press on wind deflector as shown to remove the top section.



Note: Avoid pulling on the wind deflector to prevent damage.

## B. THE HELMET

### INSTALLING THE WIND DEFLECTOR

1. Insert the 4 protrusions of the wind deflector in the chin of the helmet in their specific housing as shown.

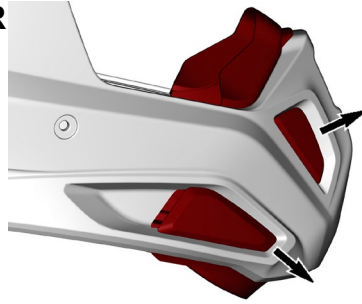

### 4. CHINSTRAP ATTACHMENT

The retention system of the PYRA helmet comes with double D-ring. This locking system is easy to use and enables you to adjust the chinstrap perfectly to your head every time you put the helmet on.

### ADJUSTING THE CHINSTRAP

1. Lead chinstrap through eyelets of both rings (1).
2. Curl back and thread through taller ring with nylon pull-tab (2).
3. Securely tighten the strap until comfortable and safe (3).
4. Press and snap buttons together to manage excess strap (4).

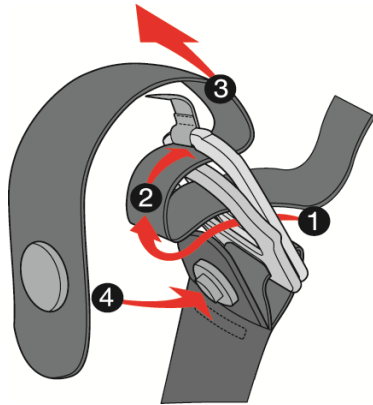

#### **⚠️ WARNING**

When adjusting the strap, make sure that the helmet cannot be pulled off in a forward direction with the chinstrap closed.

#### **⚠️ WARNING**

Never ride without making sure that the chinstrap is correctly fastened and adjusted and properly positioned. If the chinstrap is not correctly adjusted or fastened, the helmet could be displaced in the event of an accident.

#### **⚠️ WARNING**

Closing the comfort pad of the chinstrap alone will not provide adequate protection. The chinstrap must always be fully fastened.

#### **⚠️ WARNING**

Never open the chinstrap while riding.

### 5. INNER LINER

The replaceable inner lining of the PYRA helmet is washable and ensures both an excellent fit and improved ventilation of the helmet.

The dual-density cheek pads have a specific 3D shape to ensure that the helmet fits comfortably around the cheeks, and the headliner provides an optimal fit all around the head.

All interior fittings are made entirely of skin-friendly material. The material used for the cheek pads and head liner has been constructed with sweat-wicking material.

When removing the lining, the cheek pads must first be detached before taking out the headband pad. When fitting the lining, remember to insert the headband pad before the cheek pads.

### PAD SIZES

Helmet size	XS	S	M	L	XL	2XL	3XL
<b>Cheek pad thickness</b>	40 mm	35 mm	35 mm	30 mm	35 mm	30 mm	20 mm
<b>Head liner thickness</b>	<b>Top</b>	8 mm	8 mm	8 mm	8 mm	8 mm	8 mm
	<b>Crown</b>	10 mm	8 mm	14 mm	12 mm	14 mm	10 mm

## B. THE HELMET

### REMOVING THE CHEEK PADS

1. Unfasten the 3 snaps to remove the first part of the pad.
2. Slide out the chinstrap to remove cheek pad completely.
3. Repeat these steps for the other side.



### INSTALLING THE CHEEK PADS

1. Before installing the cheek pads, identify the right and the left sides.
2. Fasten the 3 snaps in position. Make sure the strap is in position inside the cheek pad notch.
3. Repeat these steps for the other side.



### REMOVING THE HEAD LINER

1. The head liner is attached to the inner shell with 2 snaps (on rear section of the helmet).
2. The frontal portion, with 2 snaps. They can be removed by pulling them out carefully.

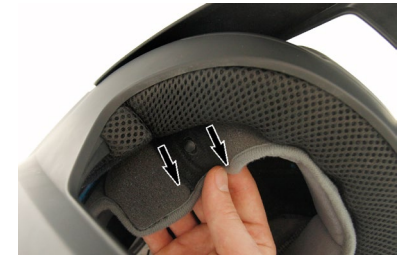

For the frontal portion, start to pull from one side of the plastic strip.

3. Next, pull the upper part of the head liner, to detach the Velcro™.





## B. THE HELMET

### INSTALLING THE HEAD LINER

1. Fasten the 2 snaps of head liner and attach the Velcro™ upper part in position.

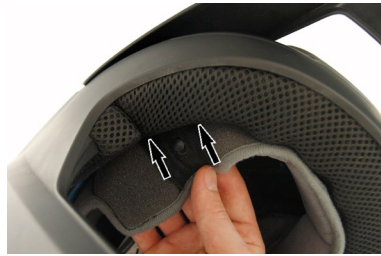

2. Next, position the head liner inside the helmet.

3. Then, fasten the 2 snaps on the neck portion.



#### **WARNING**

Never ride when parts of the inner lining have been removed.

To avoid damage to the inner lining and inner shell, do not hang the helmet over the mirrors or handlebar grips.

### REMOVING THE PEAK PIVOT

1. Pull perpendicularly on the side of the peak as shown.

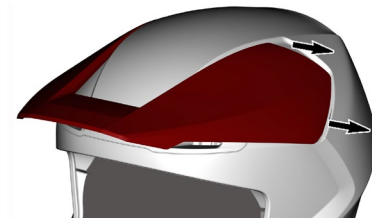

2. To remove the peak pivot, insert a screwdriver into the larger of the two holes and gently pry out.

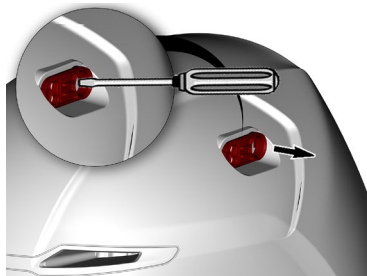

3. Repeat these steps for the other side.

#### **NOTICE**

Be careful not to damage the surface finish of the helmet.

### INSTALLING THE PEAK PIVOT

1. Insert peak pivot in the helmet in their specific housing as shown.

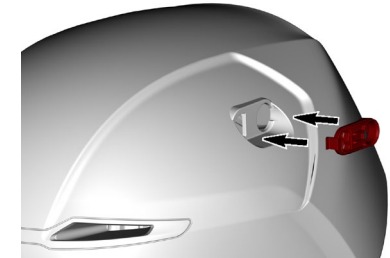

2. Install peak by pushing it in peak pivot as shown.

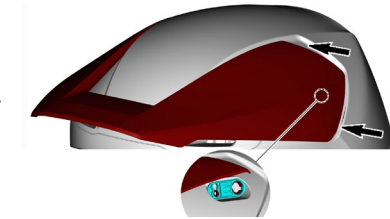

Note: Make sure that the front pin of peak is aligned with the opening in the peak pivot.

3. Repeat these steps for the other side.

4. Check that the peak mechanism is working correctly.



## C. FIT & USAGE

### 1. HOW TO PUT THE HELMET ON

1. Open the chinstrap and chinstrap comfort pad.
2. Pull apart the lower ends of the chinstrap.
3. It will now be easy to put the helmet on.
4. Close and fasten the chinstrap.
5. Make sure the chinstrap passes under the chin and fits snugly.

### 2. PROPER FIT

#### WARNING

Never buy a used helmet or borrow someone else's helmet. Over time the protective foam in helmets will adjust to the contours of a user's head. A used or borrowed helmet may not offer as much protection as a new helmet.

#### WARNING

Wearing the wrong helmet size can increase the risk of serious injury or death in an accident. A helmet that is too large for your head may be dislodged or knocked off in an accident.

To select the right helmet size for your head, follow the steps:

#### 1. MEASURE HEAD CIRCUMFERENCE

Have someone help you measure your head circumference and choose a helmet size close to that value. Refer to the helmet sizing table above.

Position the tape around your head, from the center of the forehead, above the ears and over the natural bump at the back of the head.

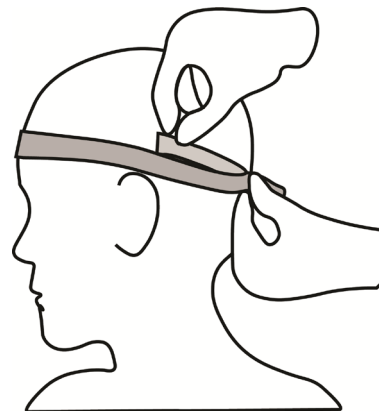

Note: Tape must be snug but not tight. If measurements fall between two sizes, order the larger size.

#### 2. TRY ON THE HELMET

Grasp both chinstraps to pull the helmet completely onto your head, ensuring that the top of your head is in contact with the top of the helmet interior. Try the helmet with all the protection you plan to use (balaclava, neck tube, face mask, etc.)

#### 3. CHECK FOR A PROPER FIT

To make sure that your helmet is the right size, check that:

- The helmet inner lining fits snugly around your head.
- The top pad presses firmly on your head.
- The cheek pads contact your cheeks.
- There is no space around your brow under the inner lining. Test this by trying to insert your fingers. If the helmet does not fit snugly, try on a smaller size.

This step might take several trials before finding the perfect adjustment.

## C. FIT & USAGE

### 4. CHECK YOUR FIELD OF VISION

Some helmets may obstruct or block your vision when looking left, right, up, or down.

#### **WARNING**

Always make sure you can see well enough to safely operate your vehicle.

### 5. TEST THE HELMET FIT

Place your hands on each side of the helmet. While holding your head as motionless as possible, try rotating your helmet from left to right then up and down. You should feel the helmet move the skin on your head and face as you try to move the helmet.

If it is not the case or if you can feel the helmet padding sliding on your head, it is too big. If the helmet is constricting or painful, it is too small.



### 6. FASTEN THE CHINSTRAP

Tighten it under your jaw until there remains no slack in the strap, and the strap must be tight up against your jaw.

### 7. TEST THE CHINSTRAP FIT

- Put your hands on the back of the helmet and try to push the helmet off by rotating it forward.
- Put your hands on the front of the helmet above your forehead (or on the chin guard) and try to push.
- If helmet comes off, try another size or model.

Repeat steps 1 through 6 until you find a helmet that fits your head snugly and securely.

### 3. HOW TO TAKE THE HELMET OFF

1. Open the chinstrap.
2. Hold the lower ends of the chinstrap and pull them apart to ease removal.
3. The helmet can now be removed easily from the head.

To avoid scratching any objects you might place the helmet on, we recommend closing the chinstrap after you have taken the helmet off.

## C. FIT & USAGE

### 4. PROPER USAGE

#### WARNING

To reduce the risk of serious injury or death and to help prevent damage to your helmet:

**Never ride with a visor that does not allow you to see clearly**

– Scratch, deterioration, fogging can impair your vision. Some tinted visors might not be safe in night riding.

**Never adjust your helmet accessories while riding** – Only make helmet adjustments when stopped.

**Always wear eye protection** – If you are not using a helmet with a visor, always wear eye protection when riding. Always lock your visor in place when you are riding. Internal sun visor is not considered as a face shield.

**Never wear a dark or tinted main visor in dark or poor visibility riding conditions.** This is not only unsafe, but also illegal in most states. Never wear a sun visor that has become scratched, or ride with a main visor that is fogged by condensation.

**Always be alert for sounds** – Your helmet may impair your hearing. However, your helmet is not a form of hearing protection.

**Always wear appropriate protection against frostbite** – Frostbite can happen when using your helmet in cold weather. Protection may include a balaclava, neck tube, facemask, or combination of these items.

### 5. PROPER HELMET HANDLING

#### WARNING

To reduce the risk of serious injury or death and to help prevent damage to your helmet:

**Never place your helmet where it could easily roll off or fall and impact the ground causing damage to the helmet** – It is best to place your helmet on the ground so it cannot fall in any direction.

**Never drop your helmet** – Dropping your helmet may crack the shell or damage the protective foam. The damage may not be visible. Your helmet is only designed for ONE impact.

**Never use insect repellent on or around your helmet** – Insect repellent may damage your helmet's visor, shell, protective foam, or other components.

**Never expose helmet to gasoline or gasoline fumes** – Gasoline may damage your helmet's visor, shell, protective foam, or other components. Other substances may damage your helmet, see proper care section.

**Always store your helmet in a helmet bag** – When not in use to help reduce accidental surface damage.

## D. BEFORE EVERY RIDE

### 1. CHECKING THE HELMET

Regularly inspect your helmet for damage. Small superficial scratches will not impair the protective function of your helmet.

#### **WARNING**

In the case of more serious damage (cracks, dents, flaking and cracking paint, etc.), the helmet should no longer be used.

#### **WARNING**

Never ride with the chinstrap unfastened or incorrectly adjusted. The chinstrap should fit correctly and should not become loose when pulled. The fastener is not correctly closed if the chinstrap becomes loose when pulled.

## E. OTHER IMPORTANT INFORMATION

### 1. MODIFICATIONS / ACCESSORIES

#### WARNING

Original components (in particular on the outer shell, inner shell and restraint system) should not be altered or removed.

Remember that installing unapproved accessories or doing any helmet modification can reduce the protective effect, renders the certification, all warranty and insurance claims invalid.

Use only original parts, replacement parts and accessories that BRP has expressly approved for your helmet!

Modifying your helmet may reduce its ability to protect you and increase your risk of serious injury or death in an accident.

Modifications include the following:

- Drilling holes
- Cutting shell, strap or shock absorbing liner
- Pressing shock absorbing liner
- Modifying the retention system, including adding a chin cup
- Removing parts
- Painting
- Using adhesives
- Installing unapproved accessories

### 2. FROSTBITE

#### WARNING

#### **What is frostbite?**

Frostbite can be defined as the freezing of the skin and/or the bodily tissues under the skin. It is thermal injury that can result from prolonged exposure to moderate cold or brief exposure to extreme cold.

#### **What causes frostbite to occur?**

Different factors can contribute to the occurrence of frostbite such as:

- Length of time a person is exposed to the cold;
- Temperature outside;
- Force of the wind (wind-chill factor);
- Humidity in the air;
- Wetness of clothing;
- Previous frostbite or cold injury.

#### **How to prevent frostbite**

- Do not go outdoors for prolonged periods in severely cold weather.
- Always wear additional headwear such as a balaclava, neck tube, face mask, or a combination of those items.
- Change any wet clothes immediately.
- Watch for signs of frostbites frequently: Red or pale skin, prickling and numbness.
- Avoid caffeine, tobacco and alcohol when going out in the cold, as these leave the skin more prone to thermal injury;

#### **Sources:**

- National Institutes of Health's Website:

<https://medlineplus.gov/frostbite.html>

<https://medlineplus.gov/ency/patientinstructions/000866.htm>

## F. CARE AND MAINTENANCE

### WARNING

Never use petroleum-based chemicals, solvents, gasoline, cleaning agents or adhesives to clean the shell, liners, or visors of your helmet. Your helmet shell, liner and visors may be seriously damaged by the use of such products and the full safety function of the helmet can then no longer be guaranteed.

### 1. SHELL CLEANING

To clean the helmet shell, only use warm mild soapy water or commercially available mild soaps made for that purpose.

Using water and soap is usually sufficient. Make sure when using any other cleaning materials that these do not risk damaging the cleaned surfaces.

### 2. INTERIOR CLEANING

The inner lining of the PYRA helmet can be removed completely.

The head and cheek pads can be washed by hand using a mild soap solution (e.g. with highly diluted standard mild detergent) at a maximum temperature of 30 °C.

Hand washing is recommended, but machine washing is also permitted. Use the "delicate" cycle to prevent the agitator from damaging the sweat-wicking material covering the liner parts. Allow the lining to dry at room temperature and with good ventilation.

### WARNING

Do not place lining parts in the dryer: Excess heat may damage the foam and coverings.

### 3. HELMET INSPECTION

Check for helmet damages. If your helmet is damaged or cracked, stop using it immediately and replace it.

Check for worn or damaged parts. Plastic components may wear out over time. If you find worn or damaged parts, replace them, or purchase a new helmet. See "Replacement parts" for information on parts replacement.

### WARNING

To reduce the risk of serious injury or death, always inspect your helmet before each ride.

The helmet should be replaced 3 to 5 years after the date of purchase, depending on use and care. Although the outer shell is in principle capable of a longer service life, the occurrence of material fatigue and wear to other components, as well as the overall action of the helmet and the unknown conditions in which the helmet has been used, make it advisable for your own safety to replace the helmet after this period of use.

Excessive heat (e.g. exhaust heat) can cause damage to the helmet esthetics, the inner shell of the helmet and the interior lining.

### 4. HELMET STORAGE

- Store helmet in a cool and dry place;
- Keep helmet away from pets and other animals;
- Keep helmet away from heat more than 50°C (122°F) and do not set on or near hot surfaces;
- Store helmet in a helmet bag.

### WARNING

Improperly stored helmet can become damaged.

## G. TROUBLESHOOTING GUIDE

PROBLEM	ACTION
PEAK	1. Peak doesn't maintain its position: - Verify if the peak inserts are broken. Replace if necessary.

## H. ACCESSORIES AND REPLACEMENT PARTS

Remember that installing unapproved accessories **or** doing any helmet modification is forbidden on a certified helmet for safety purposes.

You will find a summary of all available accessories and spare parts on internet at [www.brp.com](http://www.brp.com)

### **WARNING**

For safety reasons, all accessories should be approved by BRP for that specific helmet.

### **WARNING**

Use of replacement parts other than the ones offered by BRP may increase your risk of serious injury or death and will void the certification. Only use parts that are specifically designed to work with this helmet. BRP recommends that all replacement parts shall be installed by a BRP dealer.

### **WARNING**

Never modify your helmet – It may reduce your helmet's ability to protect you and increase your risk of serious injury or death in an accident.

## 1. REPLACEMENT PARTS

Original BRP parts are available at your authorized BRP dealer. To find BRP dealers in your area, use the dealer search on the BRP website: [www.brp.com](http://www.brp.com)

- Peak for PYRA helmet #929041
- PYRA headliner
- PYRA cheek pads
- PYRA wind deflector
- Can-Am PYRA peak
- Can-Am PYRA Dune peak
- PYRA peak pivots

**Note:** For more information on available replacement parts, please visit our website at the following address: <http://store.ski-doo.com/>



## I. BRP SERVICE

### 1. REPAIR SERVICE

The PYRA helmet is a BRP quality product that has been designed and manufactured using the latest development and production methods. If a repair to your helmet is necessary, please consult your authorized BRP dealer or distributor.

Upon receipt of a claim, BRP may examine the item and/or delay completion of the claim until the analysis is completed.

Even where a clear description of the original fault has been provided, if BRP discover further defaults during the repair, BRP may rectify these without a specific order if this is necessary to restore the correct functioning of the helmet.

### 2. LIMITED WARRANTY

Buying your helmet at an authorized BRP dealer provides a limited warranty for purchased equipment on manufacturing defects.

The limited warranty period is 4 years from the purchasing date. Should you have a reason to complain, please contact authorized BRP dealer. BRP ask that you provide a precise description of the claim as well as a copy of your receipt.

For your nearest authorized BRP dealer or distributor or for more information on BRP products, please visit our web site: [www.brp.com](http://www.brp.com)  
© ™ and the BRP logo are trademarks of Bombardier Recreational Products inc. or its affiliates.  
© 2022. Bombardier Recreational Products Inc.  
BRP\_20220115\_R00EN

## J. HOW TO CONTACT US

### North America

565 de la Montagne Street  
Valcourt (Québec) J0E 2L0  
Canada

Sturtevant, Wisconsin, U.S.A.  
10101 Science Drive  
Sturtevant, Wisconsin  
53177  
U.S.A.

Sa De Cv, Av. Ferrocarril 202  
Parque Ind. Querétaro, Lote2-B  
76220  
Santa Rosa Jáuregui, Qro.  
Mexico

### Oceania

6 Lord Street  
Lakes Business Park  
Botany, NSW 2019  
Australia

### South America

Rua James Clerck Maxwell, 230  
TechnoPark Campinas  
SP 13069-380  
Brazil

### Asia

15/F Parale Mitsui Building,8  
Higashida-Cho, Kawasaki-ku  
Kawasaki 210-0005  
Japan

Room Dubai, level 12, Platinum  
Tower  
233 Tai Cang Road  
Xintiandi, Lu Wan District  
Shanghai 200

### Europe

Skaldenstraat 125  
B-9042 Gent  
Belgium

Itterpark 11  
D-40724 Hilden  
Germany

ARTEPARC Bâtiment B  
Route de la côte d'Azur, Le  
Canet  
13590 Meyreuil  
France

Ingvald Ystgaardsvei 15  
N-7484 Trondheim  
Norway

Isoaavantie 7  
PL 8040  
96101 Rovaniemi  
Formvågen 16  
S-906 21 Umeå  
Sweden

Avenue d'Ouchy 4-6  
1006 Lausanne  
Switzerland