

# **EVINRUDE® ICON™ CONCEALED SIDE MOUNT REMOTE CONTROL USER'S GUIDE**

## **TABLE OF CONTENTS**

|  |    |
|--|----|
| Declaration of Conformity .....                                    | 2  |
| Safety Information .....   | 3  |
| <i>ICON</i> REMOTE CONTROL Features .....                          | 4  |
| <i>ICON</i> Single Lever Concealed Side Mount Remote Control ..... | 4  |
| Operation .....  | 5  |
| Emergency Stop Lanyard .....                                       | 6  |
| Master Power/Key Switch .....                                      | 6  |
| Station Select .....   | 7  |
| Switch Panel .....   | 8  |
| START/STOP Switch .....  | 8  |
| Shift and Throttle Control .....                                   | 9  |
| Control Lever .....  | 9  |
| FORWARD Gear .....   | 9  |
| REVERSE Gear .....   | 9  |
| NEUTRAL .....  | 9  |
| THROTTLE .....   | 10 |
| NEUTRAL Throttle Switch .....                                      | 10 |
| RPM Adjustment .....   | 10 |
| Trim and Tilt Switch .....   | 11 |
| Control Lever Trim and Tilt Switch .....                           | 11 |
| Station Protect .....  | 11 |
| Indicator LED Brightness and Gauge Backlighting .....              | 12 |
| Control Lever Friction Adjustment .....                            | 12 |
| <i>ICON</i> Network Specifications and Information .....           | 13 |
| Specifications .....   | 13 |
| <i>ICON</i> Gateway Module .....                                   | 13 |
| <i>ICON</i> Network Hubs .....                                     | 13 |
| Accessory Power Relay Kit .....                                    | 14 |
| Engine Identity Numbers .....                                      | 14 |
| Frequently Asked Questions .....                                   | 15 |
| Troubleshooting .....  | 16 |
| <i>ICON</i> Fault Messages .....                                   | 17 |
| <i>ICON</i> System Diagram .....                                   | 18 |
| Product Warranty .....   | 20 |
| Index .....  | 22 |
| Notes .....  | 23 |

# DECLARATION OF CONFORMITY

- **Application of Council Directives:**

Directive 94/25/EC as amended by 2003/44/EC – Recreational-Craft

This product has been designed to be compliant with the above Directive.

Maximum performance, and compliance with the EMC Directive, can only be ensured by correct installation. It is strongly recommended that the installation conforms with the following standards:

## ***Applicable Standards***

- **ISO 8846 Small Craft-Electrical Devices**

Protection against ignition of surrounding flammable gases.

ISO = International Standards Organization

This device meets or exceeds the applicable ABYC, ISO, and USCG safe boating rules, regulations, standards, and guidelines.

## SAFE BOATING ON THE WEB

|  |  |
|--|--|
| U.S. Coast Guard (US)                        | <a href="http://www.uscg.mil">www.uscg.mil</a>   |
| U.S. Power Squadron (US)                     | <a href="http://www.usps.org">www.usps.org</a>   |
| National Safe Boating Council (US)           | <a href="http://www.safeboatingcouncil.org/">www.safeboatingcouncil.org/</a>                 |
| Canadian Coast Guard (CA)                    | <a href="http://www.ccg-gcc.gc.ca">www.ccg-gcc.gc.ca</a>                                     |
| The Royal National Lifeboat Institution (UK) | <a href="http://www.rnli.org.uk">www.rnli.org.uk</a>   |
| The Boat Safety Scheme (UK)                  | <a href="http://www.boatsafetyscheme.com">www.boatsafetyscheme.com</a>                       |
| Safe Boating Australia (AU)                  | <a href="http://www.safeboating.org.au">www.safeboating.org.au</a>                           |
| NSW Maritime (AU)                            | <a href="http://www.maritime.nsw.gov.au">www.maritime.nsw.gov.au</a>                         |
| Marine Safety Victoria (AU)                  | <a href="http://www.marinesafety.vic.gov.au">www.marinesafety.vic.gov.au</a>                 |
| Maritime Safety Queensland (AU)              | <a href="http://www.msq.qld.gov.au/">www.msq.qld.gov.au/</a>                                 |
| Transport South Australia (AU)               | <a href="http://www.transport.sa.gov.au/">www.transport.sa.gov.au/</a>                       |
| Recreational Boating Safety (AU)             | <a href="http://www.dpi.wa.gov.au/imarine/19078.asp">www.dpi.wa.gov.au/imarine/19078.asp</a> |

## SAFETY INFORMATION

This User's Guide uses the following signal words identifying important safety messages.

### **DANGER**

Indicates a hazardous situation which, if not avoided, will result in death or serious injury.

### **WARNING**

Indicates a hazardous situation which, if not avoided, could result in death or serious injury.

 **CAUTION** Indicates a hazardous situation which, if not avoided, could result in minor or moderate injury.

**NOTICE** Indicates an instruction which, if not followed, could severely damage engine components or other property.

**IMPORTANT:** Identifies information that will help with assembly and operation of the product.

This User's Guide contains essential information to help prevent personal injury and damage to equipment. Use the *ICON* User's Guide in combination with the boat and engine operator's guides. Always follow safety and operation information.

Be careful! Human error is caused by many factors: carelessness, fatigue, overload, pre-occupation, unfamiliarity of operator with the product, drugs and alcohol to name a few. Damage to your boat and outboard can be fixed in a short period of time, but injury or death, has a lasting effect.

### **WARNING**

This device should not be used as a navigational aid to prevent collision, grounding, boat damage, or personal injury. When the boat is moving, water depth may change too quickly to allow time for you to react. Always operate the boat at very slow speeds if you suspect shallow water or submerged objects.

### **WARNING**

This product contains lead, a chemical known to the State of California to cause cancer, birth defects, and other reproductive harm.

Read and familiarize yourself with the complete *ICON Remote Control User's Guide* before attempting to start the outboard.

## ICON REMOTE CONTROL FEATURES

The *ICON* single lever concealed side mount remote control is used in single engine installations. Use the *ICON* single lever concealed side mount remote control for single station installations.

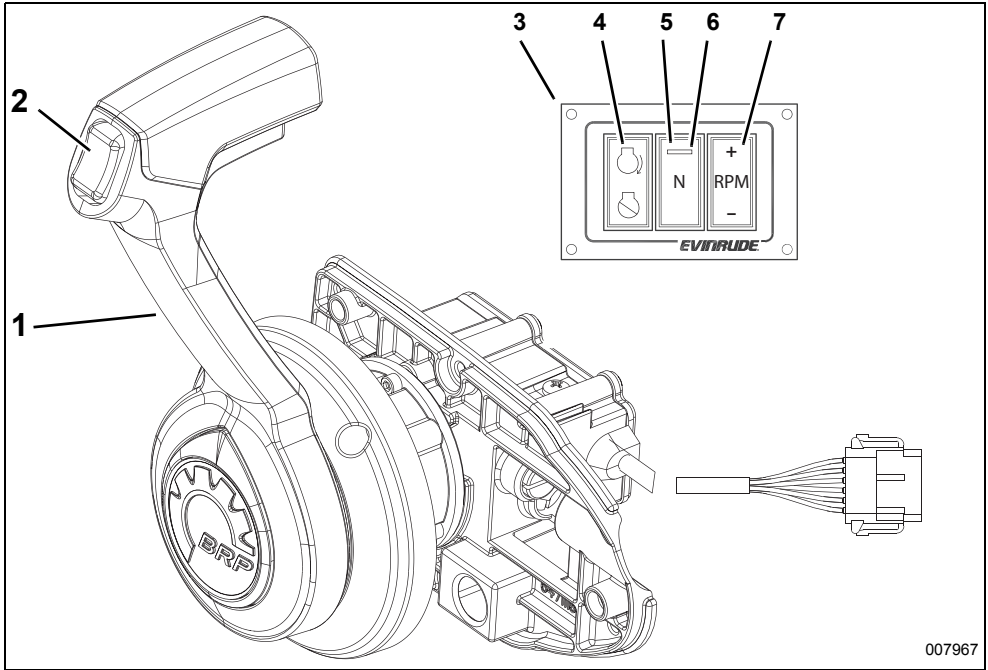

007967

|   | Feature                     | Function  |
|---|-----------------------------|---|
| 1 | Control Lever               | Controls shift and throttle function for outboard.                    |
| 2 | Master Trim Switch          | Press to adjust trim setting of all outboards.                        |
| 3 | Switch Panel                | Contains Neutral Throttle, RPM and START /STOP switches.              |
| 4 | START/STOP Switch           | Press to START or STOP the engine.                                    |
| 5 | NEUTRAL Throttle Switch (N) | Press to disengage shift function. Allows for throttle only function. |
| 6 | NEUTRAL Indicator LED       | Turns yellow when control lever is shifted into NEUTRAL position.     |
| 7 | RPM Switch                  | Press + or – to make slight adjustments to engine speed.              |

## OPERATION

Operators should be familiar with nautical orientation.

This User's Guide often identifies outboards, parts or procedures using terms shown in the diagram below.

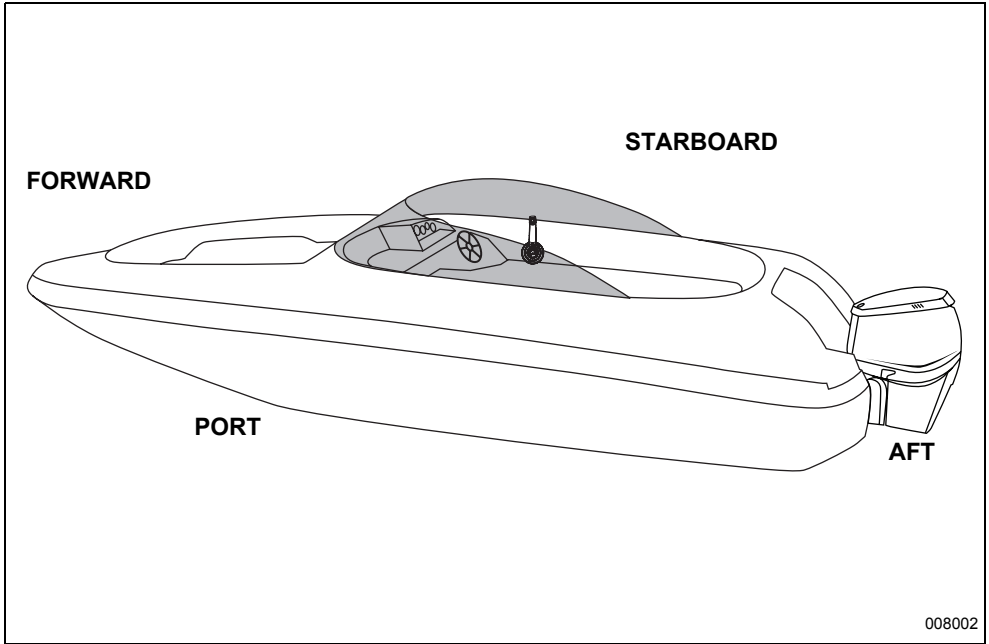

## Emergency Stop Lanyard

Snap the emergency stop lanyard to a **secure** place on the operators clothing or life vest – not where it might tear away instead of activating the stop switch.

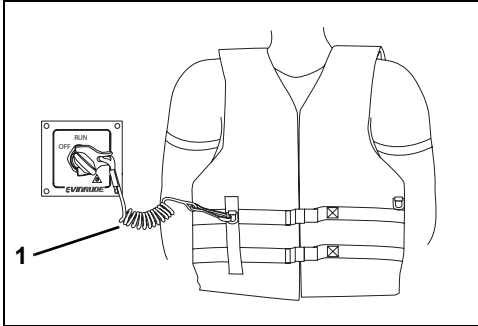

1. Emergency stop lanyard

005499

## WARNING

**Emergency stop lanyard MUST be securely attached to the operator, and clip MUST be installed on master power/key switch. DO NOT operate outboard with clip removed from switch, except in an emergency.**

Disconnecting the clip of the emergency stop lanyard from the master power/key switch will stop all engines and prevent the boat from becoming a runaway if the driver moves beyond the range of the lanyard. If the lanyard is too long, it can be shortened by knotting it or looping it. **DO NOT** cut and retie the lanyard.

## WARNING

**Avoid knocking or pulling clip off the stop switch during normal boating. Avoid bumping the key if operating without the clip on the switch. The resulting unexpected loss of forward motion can throw occupants forward causing injury.**

**Keep the lanyard free from obstructions and entanglements.**

**At each outing, test the system's operation. With the engine running, remove clip from the switch by pulling the lanyard. If the engine does not stop running, see your dealer.**

## Master Power/Key Switch

Push the clip of emergency stop lanyard onto the master power/key switch.

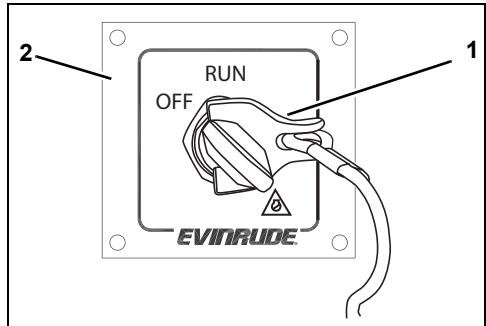

1. Clip of emergency stop lanyard

007895

2. Master power/key switch

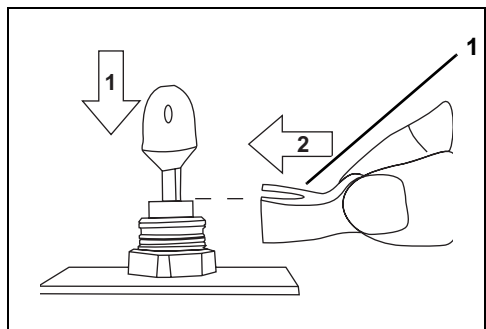

1. Clip of emergency stop lanyard

007896

In an emergency situation the engine can be restarted without the clip in place. Follow normal starting procedure. Reinstall clip as soon as possible. See your dealer to order a spare Emergency Stop Lanyard, P/N 176288.

### Station Select

Station select is the process of activating a remote control station during system power up.

**⚠ CAUTION** If **Station Protect** is enabled, a unique key sequence must be entered to activate the station. See **Station Protect** on page 11.

Turn the master power/key switch to the RUN position.

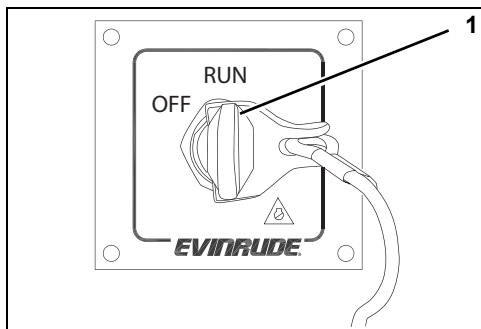

1. RUN position

007894

The master power/key switch turns power ON and OFF to the:

- ICON control network
- Outboard
- NMEA 2000/gauge network
- Boat accessories (requires Accessory Power Relay Kit, P/N 765296)

In single station installations, the remote control activates automatically.

**Note:** Position control lever in the NEUTRAL position to start or stop outboard. A NEUTRAL indicator Light Emitting Diode (LED) located on the switch panel will turn ON to indicate control lever is in NEUTRAL position.

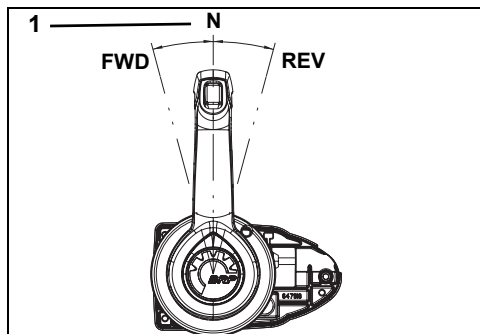

1. NEUTRAL position

008005

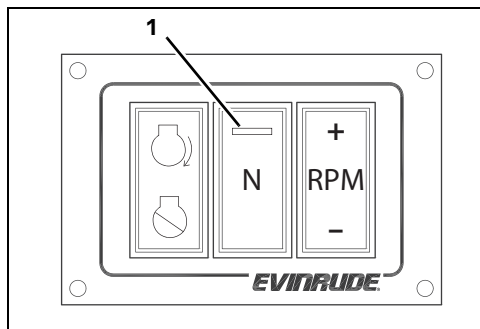

1. NEUTRAL indicator LED

008003

### Switch Panel

A switch panel is located at the operator station. The switch panel contains the START/STOP switch, a NEUTRAL switch and an RPM switch.

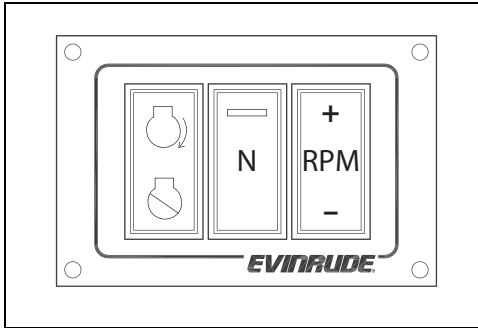

Switch Panel

008003

Press and release the STOP symbol of switch to stop the outboard.

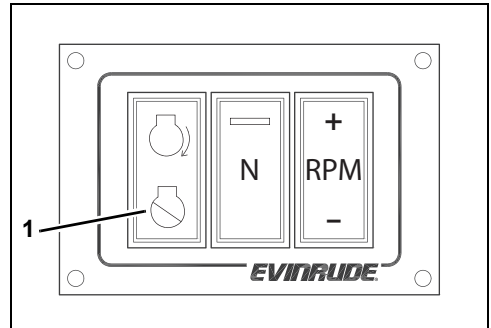

1. STOP symbol

008003

### START/STOP Switch

Press the START symbol of switch to start the outboard. Crank the engine no longer than 20 seconds.

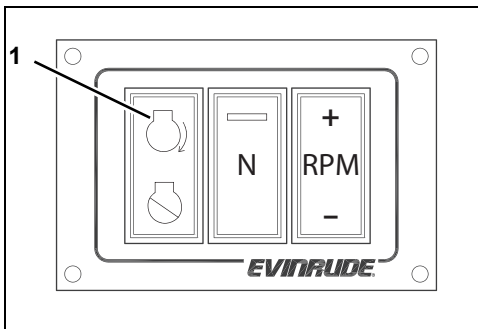

1. START symbol

008003

Turn the master power/key switch to the OFF position.

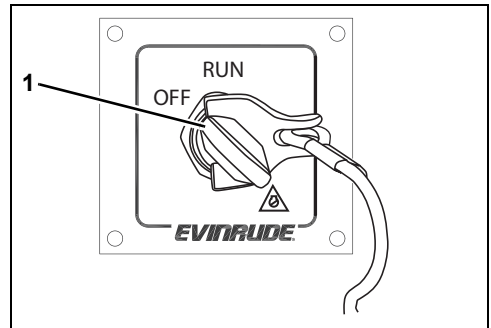

1. OFF position

007895

**NOTICE** The starter motor can be damaged if operated continuously for more than 20 seconds.

Upon start-up, release the switch.



## Shift and Throttle Control

**IMPORTANT:** Carefully check the function of all control and engine systems before leaving the dock. DO NOT shift the engine into FORWARD or REVERSE while the engine is stopped. Shift ONLY when the engine is running.

### Control Lever

Control lever shift and throttle range is as shown.

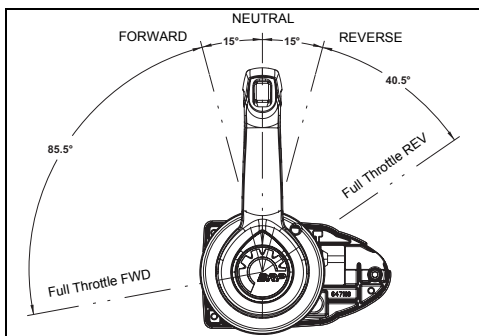

008004

### FORWARD Gear

Move the control lever to the forward position. The NEUTRAL indicator LED turns OFF and the outboard shifts into FORWARD (FWD) gear.

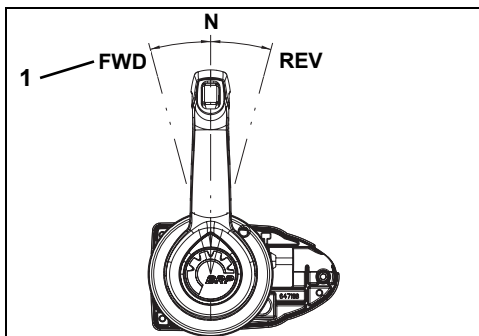

1. FORWARD position

008005

### REVERSE Gear

Move the control lever to the reverse position. The NEUTRAL indicator LED turns OFF and the outboard shifts into REVERSE (REV) gear.

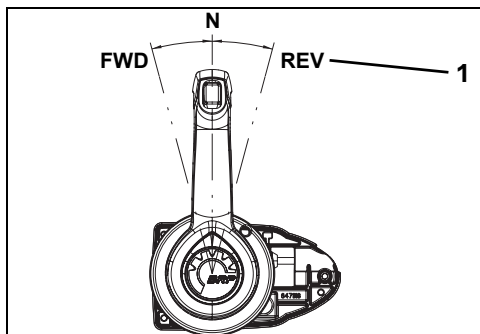

1. REVERSE position

008005

### NEUTRAL

Move the control lever to the NEUTRAL (N) position.

The NEUTRAL indicator LED turns ON and the outboard shifts into NEUTRAL.

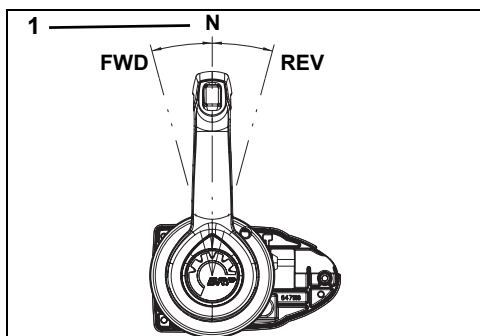

1. NEUTRAL position

008005

**Note:** The *ICON* system delays gear changes until engine speeds are below 1500 RPM.

## Operation

### THROTTLE

After shifting, move the control handle slowly in the same direction to increase speed.

For FORWARD gear, move control lever in a forward direction to increase speed.

For REVERSE gear, move control lever in an aft direction to increase speed.

Reverse throttle range is limited to a maximum of 60% power.

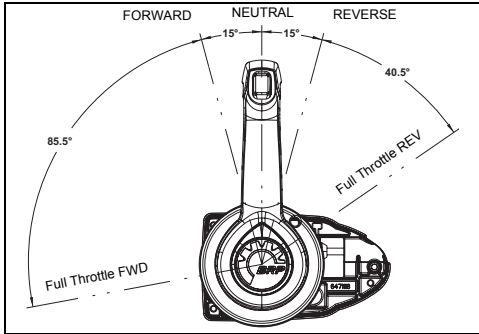

### NEUTRAL Throttle Switch

The NEUTRAL throttle switch (N) allows operation of the throttle without shifting the outboard into FORWARD or REVERSE gear.

Press the **N** switch. The NEUTRAL indicator LED flashes. Advance the control lever in a forward direction to increase engine speed.

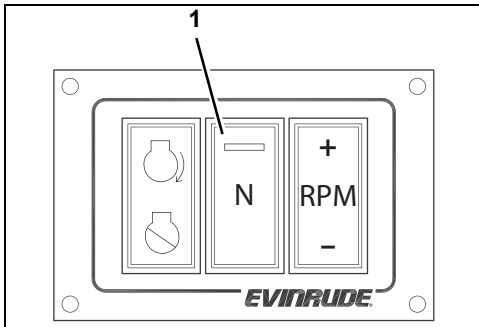

During normal operation, the Engine Management Module (EMM) of the outboard limits engine speed to 1200 RPM while in NEUTRAL.

Return the control lever to the NEUTRAL position and press the **N** switch to deactivate NEUTRAL throttle switch. The NEUTRAL indicator LED stops flashing.

Use NEUTRAL throttle for warm-up and to perform the long-term storage (winterization) procedure. See **Outboard Operator's Guide** and **I-Command User's Guide**.

**Note:** During the long-term storage/winterizing procedure, engine speed will be between 1200 to 2600 RPM. Refer to **LONG-TERM STORAGE (WINTERIZATION)** in outboard's **Operator's Guide**.

### RPM Adjustment

The **RPM** adjustment switch allows the operator to gradually adjust engine RPM.

RPM adjustment range is limited to 5% of the throttle setting. Each press of the **RPM** switch changes throttle setting 1%. The adjustment range is approximately 100 to 200 RPM depending on engine speed.

**IMPORTANT:** To use the RPM adjustment feature, the control lever **MUST** be in FORWARD gear and engine speed must be above 500 RPM.

Press the **+** side of the **RPM** switch to increase engine speed. Press the **-** side of the **RPM** switch to decrease engine speed.

1. N switch

008003

Reposition the control lever and start the process again for further adjustment. To cancel the RPM adjustment switch setting move the control lever to a faster or slower position.

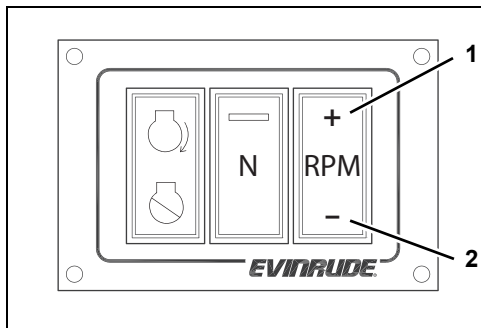

1. + side of RPM switch
  2. - side of RPM switch
- 008003

## Trim and Tilt Switch

### Control Lever Trim and Tilt Switch

The trim and tilt switch on the control lever allows the operator to trim or tilt the outboard.

- Press the **UP** side of the trim and tilt switch to trim the outboard up.
- Press the **DOWN** side of the trim and tilt switch to trim the outboard down.

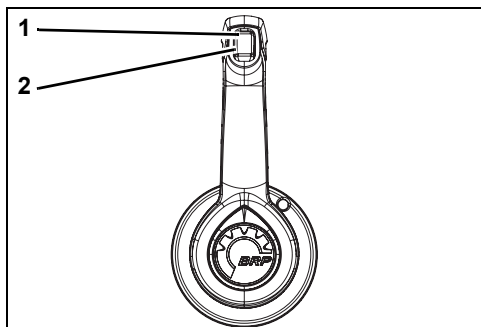

1. UP side of trim and tilt switch
  2. DOWN side of trim and tilt switch
- 008006

## Station Protect

When Station Protect is turned ON, a unique key sequence must be entered to activate a station and start, run and control all outboards.

**Note:** "Station Protect" is normally used in dual station applications and this feature limits use of control stations. Station Protect must be set up during installation. Dealers must use *Evinrude Diagnostics* software to reprogram the Engine Management Module (EMM) to turn ON this option.

To activate the station, press the **+** side of the **RPM** switch and the **N** switch in this sequence:

- 1) Press the **+** side of the **RPM** switch first,
- 2) Press the **+** side of the **RPM** switch second,
- 3) Press the **N** switch third and
- 4) Press the **+** side of the **RPM** switch last.

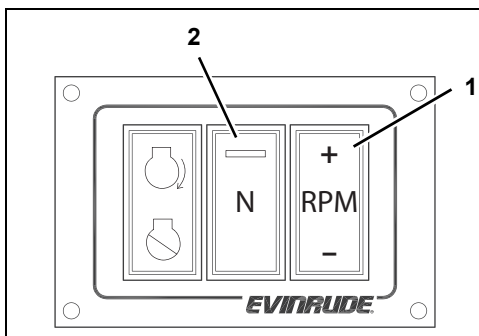

1. + side of RPM switch
  2. N switch
- 008003

## Indicator LED Brightness and Gauge Backlighting

The **RPM** switch also allows the operator to adjust the brightness of indicator LEDs on the control base and the backlighting of the NMEA 2000/I-Command gauges.

**IMPORTANT:** The control lever **MUST** be in the NEUTRAL position.

To change the brightness of indicator LEDs and gauge backlighting, press:

- the **+** side of the **RPM** switch to brighten
- the **-** side of the **RPM** switch to dim.

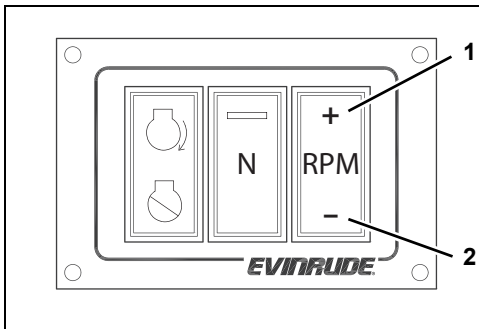

1. **+** side of **RPM** switch
2. **-** side of **RPM** switch

## CONTROL LEVER FRICTION ADJUSTMENT

Check control lever friction adjustment. When properly adjusted, the control lever should have low friction to allow easy movement in the throttle range, and not allow vibration to change the throttle setting.

Remove cover from control lever. Use a 5/32 in (4 mm) hex tool to adjust friction adjustment screw. Turn the adjustment screw clockwise to increase the friction or counterclockwise to reduce the friction.

### Throttle Friction

This adjustment is used to increase or reduce the force required to move the control lever through the throttle range.

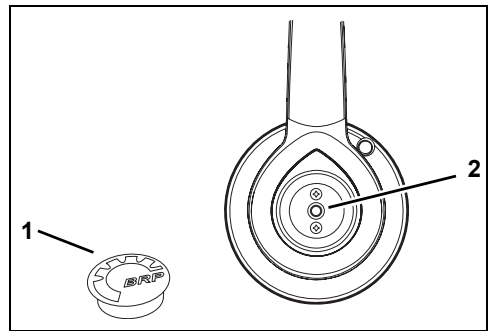

1. Cover
2. Throttle friction adjustment screw

## ICON NETWORK SPECIFICATIONS AND INFORMATION

### Specifications

|  |  |
|--|--|
| Supply Voltage (Boat System)                                 | 9 to 18 VDC                              |
| Operating Voltage ( <i>ICON</i> Control Network)             | 5 VDC                                    |
| Engine Control   | 1, 2, 3, 4, or 5 outboards               |
| Reverse Polarity Protection                                  | Continuous                               |
| Fuse, Network  | 10 Amp, ATO Type, P/N 967545             |
| Fuse, Master Power/Key Switch                                | 3 Amp, ATO Type, P/N 764538              |
| Fuse, Electronic Servo Module                                | 30 Amp, Minifuse Type, P/N 5032630       |
| Fuse, Accessory Power Relay Kit                              | 10 Amp, Minifuse Type, P/N 514766        |
| Network Interface  | Proprietary, based on NMEA 2000 standard |
| Operating Temperature Range                                  | -13° to 167° F (-25° to 75° C)           |
| Maximum Current Draw<br>(Master Power/Key Switch turned OFF) | 10µA                                     |

### ICON Gateway Module

The *ICON* gateway module provides network data to the NMEA 2000 network and *I-Command* gauges.

The gateway module receives power from the network power cable. When the gateway is powered and receiving data from the network the LED on the gateway module turns ON.

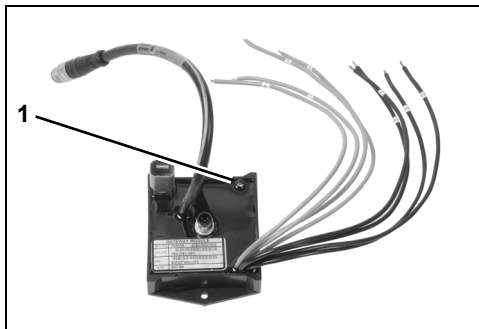

1. LED on gateway module

007913

The gateway module provides fuel level monitoring for up to four fuel tanks when connected to fuel level senders.

### ICON Network Hubs

*ICON* network hubs are used to connect buss cables to remote controls, gateway module, master power/key switch and to other devices on the network.

Two hubs **MUST** be installed in the *ICON* network. See **ICON System Diagram** on page 18.

Protective covers must be used to seal unused connections.

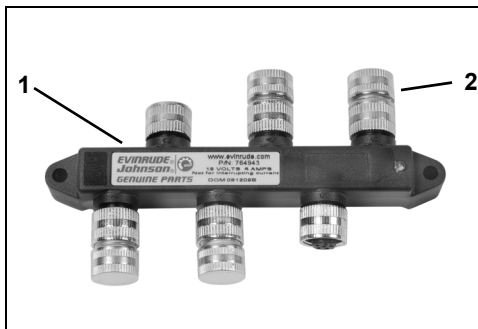

1. *ICON* network hub  
2. Protective cover

007945

### Accessory Power Relay Kit

Accessory Power Relay Kit, P/N 765296, must be used to power boat accessories which require switched B+. This kit is used in place of connecting accessories to the “A” terminal of the key switch.

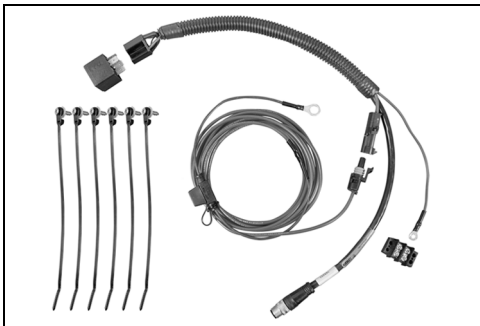

Accessory Power Relay Kit

007940

### Engine Identity Numbers

Engine identity numbers are assigned to the Electronic Servo Module (ESM) and Engine Management Module (EMM) of each outboard. Engine identity numbers allow the *ICON* network to correctly control the outboards.

**Note:** Engine identity numbers assignment is critical in multiple engine installations. Single engine installations normally require no change to identity number assignment.

The table below lists typical engine identity number assignment.

| Number of Outboards | Identity Numbers |             |        |                  |           |
|---------------------|------------------|-------------|--------|------------------|-----------|
|                     | Port             | Port Center | Center | Starboard Center | Starboard |
| 1                   | 0                |             |        |                  |           |
| 2                   | 0                |             |        |                  | 1         |
| 3                   | 0                |             | 1      |                  | 2         |
| 4                   | 0                | 1           |        | 2                | 3         |
| 5                   | 0                | 1           | 2      | 3                | 4         |

Each outboard is identified by an engine identity plug installed in its ESM.

The first time the *ICON* system is turned ON, it automatically checks engine identity numbers. During this time, the controls will not respond to operator inputs. Allow approximately 3 seconds per engine for this check to complete.

Check the engine identity plug number and be sure the engine identity plug is installed as outlined in the table.

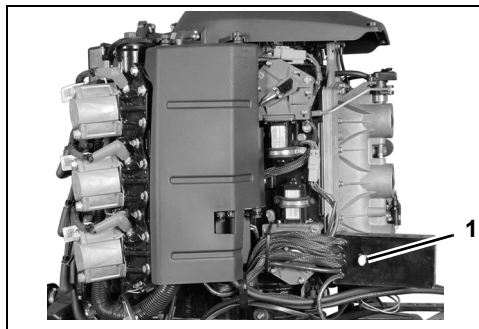

1. Engine identity plug

007525

**IMPORTANT:** Do not exchange ESMs or EMMs between outboards. Severe engine damage can result from improper replacement of ESM or EMM.

## FREQUENTLY ASKED QUESTIONS

**Q:** Does the *Evinrude ICON* electronic shift and throttle system require periodic calibration?

**A:** No. Normal use does not require periodic calibration. However, the system **MUST** be calibrated if the following services are performed:

- Replacement of throttle or shift actuator
- Replacement of Electro Servo Module (ESM)
- Replacement of Throttle Position Sensor (TPS)
- Shift linkage removal/installation
- Powerhead removal/installation
- Gearcase removal/installation

System calibration requires *Evinrude Diagnostics* software, version 4.0 or higher. See an authorized *Evinrude* dealer when this important procedure is required.

**Q:** How do I make a flashing NEUTRAL indicator LED stop flashing?

**A:** Check emergency stop lanyard is in place. Move control lever to NEUTRAL position. Reset the *ICON* system by turning the master power/key switch to the OFF position and then back to the RUN position.

**Q:** The Station Protect feature does not appear to be working. What can cause this?

**A:** This option must be turned ON in the outboard's Engine Management Module (*EMM*). Your dealer must use *Evinrude Diagnostics* software (version 4.0 or higher) to turn ON this feature.

**Q:** My boat only has one fuel tank. Can the gateway module be configured to read other fluid levels, such as "Oil Level" or "Water Level"?

**A:** No. The gateway module only provides a fuel level monitor. It cannot be configured to read other fluid levels. See an authorized *Evinrude* dealer for accessory fluid level sensors.

# TROUBLESHOOTING

| Observation  | Possible Cause   | Procedure  |
|--|--|--|
| <i>ICON</i> system does not power up.  | Network power cable 10 Amp fuse has failed.  | Check network power cable and connections for damage or short circuit to ground.   |
|  | Master power/key switch/network 3 Amp fuse has failed.   | Check master power/key switch cable, buss cable backbone, all buss cable extensions and connectors for damage or short circuit to ground.                          |
| <i>ICON</i> Fault Message displayed. Also see <b>ICON Fault Messages</b> on p. 23. | Communication error (fault 107) or failsafe mode (fault 108). ESM 30 Amp fuse has failed.  | Check ESM power cable, actuator cables and all connectors for damage or short circuit to ground.   |
|  | Communication errors or faults (107 or 111) may be caused by low battery voltage.  | Check condition of batteries, battery connections and/or battery switches. Check all network connections between control, ESM and outboard <i>EMM</i> .            |
| Outboard(s) will not shut off with START/STOP switch.                              | Outboards must have <i>ICON</i> -compatible engine management software installed in the Engine Management Module ( <i>EMM</i> ). | If this problem has occurred after installing an <i>ICON</i> conversion kit, an authorized <i>Evinrude</i> dealer must install updated engine management software. |
| Outboard will not trim/tilt up and/or down.  | Master power/key switch must be in RUN position.   | Turn master power/key switch to RUN position.  |
|  | Outboards must have <i>ICON</i> -compatible engine management software installed in the Engine Management Module ( <i>EMM</i> ). | If this problem has occurred after installing an <i>ICON</i> conversion kit, an authorized <i>Evinrude</i> dealer must install updated engine management software. |
| NMEA 2000 network/ <i>I-Command</i> gauges are OFF.                                | Gateway module is not on.  | Check that gateway module LED is ON. Check power cable and connections from master power/key switch to gateway module.   |
|  | NMEA 2000 buss cable is not connected or is damaged.   | Check NMEA 2000 buss cable connectors.   |
| Gateway module LED flashing.   | Gateway module is not receiving data from <i>ICON</i> control network.   | Check network connections from gateway to <i>ICON</i> network hub and buss cable backbone.   |



## ICON FAULT MESSAGES

| <b>Fault Message Displayed on I-Command Gauge</b>     | <b>Procedure</b>   |
|---|--|
| RPM reduction, <i>ICON</i> fault 107, see dealer.     | <b>Communication Error</b><br>Turn master power/key switch OFF and back to RUN position to reset system. Seek assistance to return to harbor. See dealer.  |
| RPM reduction, <i>ICON</i> fault 108, see dealer.     | <b>ICON System Failsafe Mode</b><br>Seek assistance to return to harbor. See dealer.   |
| RPM reduction, <i>ICON</i> fault 109, see user guide. | <b>Control Hardware Fault</b><br><i>ICON</i> Shutdown - <i>ICON</i> system shifts into NEUTRAL idle if able. Seek assistance to return to harbor. See dealer.  |
| RPM reduction, <i>ICON</i> fault 111, see dealer.     | <b>ESM Communication Fault</b><br><i>ICON</i> Shutdown - <i>ICON</i> system shifts into NEUTRAL idle if able. Seek assistance to return to harbor. See dealer.   |
| RPM reduction, <i>ICON</i> fault 149, see dealer.     | <b>Throttle Actuator Sensor Fault</b><br><i>ICON</i> Shutdown - <i>ICON</i> system shifts into NEUTRAL idle if able. Return to harbor. See dealer.   |
| RPM reduction, <i>ICON</i> fault 150, see user guide. | <b>Throttle Actuator Motion Fault</b><br>RPM reduction (See outboard's operator's guide for S.A.F.E.) if throttle is unable to move to closed position. Move control lever to NEUTRAL position. Stop outboard. Turn master power/key switch OFF and then back to RUN position to reset system. Check throttle linkage for obstructions to. Return to harbor. See dealer.   |
| RPM reduction, <i>ICON</i> fault 151, see dealer.     | <b>Shift Actuator Sensor Fault</b><br><i>ICON</i> Shutdown - <i>ICON</i> system shifts into NEUTRAL idle if able. Seek assistance to return to harbor. See dealer.   |
| <i>ICON</i> fault 152, see user guide.                | <b>Shift Actuator Motion Fault</b><br>Shift is unable to move to FORWARD or REVERSE gear position.<br><ul style="list-style-type: none"> <li>• <b>Outboard NOT running:</b> DO NOT shift the engines into FORWARD or REVERSE while the engines are stopped. Shift ONLY when engines are running. Turn master power/key switch OFF and then back to RUN position to reset system.</li> <li>• <b>Outboard running:</b> Move control lever to NEUTRAL position. Stop outboard. Turn master power/key switch OFF and then back to RUN position to reset system. Check shift linkage for obstructions. If fault not corrected, return to harbor. See dealer.</li> </ul> |

## **/CON SYSTEM DIAGRAM**

| <b>Item</b> | <b>Description</b>                          | <b>Item</b> | <b>Description</b>             |
|-------------|---|-------------|--------------------------------|
| 1           | /CON Concealed Side Mount Remote Control    | 15          | To Positive (+) 12 Volt Source |
| 2           | Control Module                              | 16          | To Accessories                 |
| 3           | Master Power/Key Switch                     | 17          | Buss Cable, Backbone           |
| 4           | Switch Panel, START/STOP – NEUTRAL – RPM    | 18          | Protective Covers              |
| 5           | Network Power Cable, to Main Battery (12 V) | 19          | Electronic Servo Module (ESM)  |
| 6           | Fuse, Main Network - 10 Amp                 | 20          | Engine Identity Plug           |
| 7           | Fuse, Master Power/Key Switch - 3 Amp       | 21          | To Engine CANbus Connector     |
| 8           | /CON Gateway Module                         | 22          | To Engine Key Switch Connector |
| 9           | To Fuel Tank Sender(s)                      | 23          | To Engine Trim/Tilt Connector  |
| 10          | To NMEA 2000 Network/Gauges                 | 24          | To Engine Solenoid             |
| 11          | NMEA 2000 Network/Gauges                    | 25          | Fuse, ESM - 30 Amp             |
| 12          | Buss Cable, Extension                       | 26          | Shift Actuator                 |
| 13          | /CON Network Hub                            | 27          | Throttle Actuator              |
| 14          | Accessory Power Relay Kit                   |             |                                |

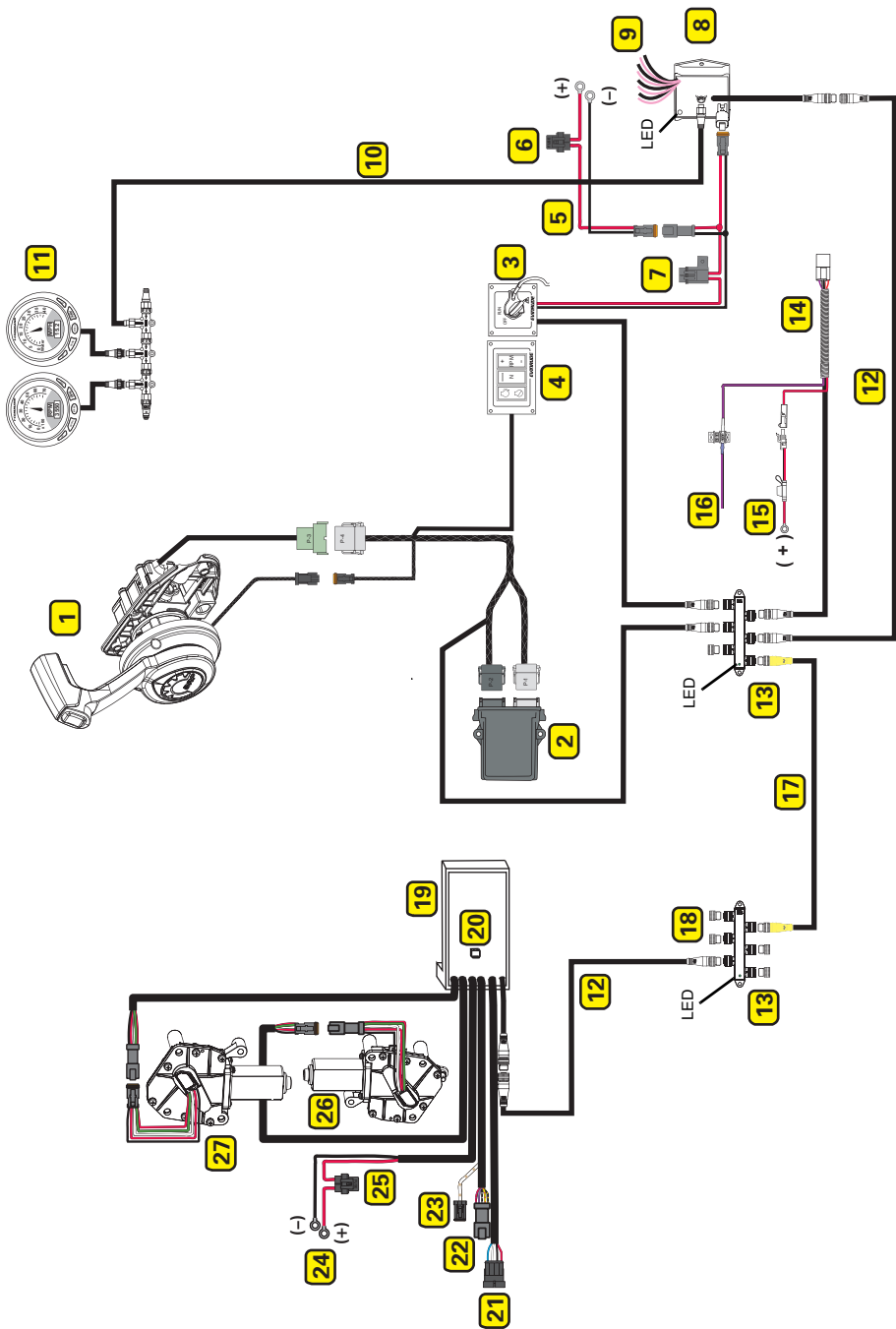

## PRODUCT WARRANTY

BRP US Inc.\* ("BRP") warrants its *Evinrude®/Johnson®* Genuine Parts and accessories ("Product") sold by authorized *Evinrude* or *Johnson* dealers in the fifty United States and Canada from defects in material or workmanship for the period and under the conditions described below. This limited warranty does not apply to Products not bearing the *Evinrude* or *Johnson* trademarks that are made by other manufacturers. This limited warranty extends to the original retail purchaser only ("Purchaser") and is not transferable to any subsequent owner. This warranty is available only on Products purchased as new and unused from a dealer authorized to distribute the Products in the country in which the sale occurred ("Dealer").

Aluminum propellers, plastic propellers, stainless steel propellers, *Snap-In™* control cables and *DuraTank™* fuel tanks are warranted for THIRTY SIX (36) CONSECUTIVE MONTHS from the date of purchase as of July 1, 2006.

*ICON™* engine control systems and components are warranted for THIRTY SIX (36) CONSECUTIVE MONTHS from the date of purchase for recreational use or TWELVE (12) CONSECUTIVE MONTHS for commercial use.

Powerhead assemblies are warranted for a period of SIX (6) CONSECUTIVE MONTHS from the date of purchase. All other Products are warranted for a period of TWELVE (12) CONSECUTIVE MONTHS from the date of purchase.

The following are not warranted under any circumstances: (a) normal wear and tear; (b) routine maintenance items including, but not limited to, adjustments, oil changes, water pumps, carburetor maintenance, spark plug replacements, etc.; (c) cosmetic damage or paint changes due to exposure to the elements; or (d) damage caused by: improper or lack of installation, maintenance, winterization and/or storage; failure to follow the procedures and recommendations in the Operator's Guide; removal of parts, improper repairs, service, maintenance, or modification; use of parts or accessories not manufactured or approved by BRP that are either incompatible with Product or adversely affect its operation, performance, or durability; repairs done by anyone, including Purchaser, other than an authorized Dealer; abuse, misuse, abnormal use, neglect, racing, improper operation or operation of Product in a manner inconsistent with the Operator's Guide; external damage, accident, submersion, water ingestion, fire, theft, vandalism or act of God; operation with fuels, oils or lubricants not suitable for use with Product (see Operator's Guide); rust or corrosion; or cooling system blockage by foreign material.

This warranty will be voided in its entirety and rendered null and void: (a) where Product has been altered or modified in such a way so as to adversely affect its operation, performance or durability, or has been altered or modified to change its intended use; or (b) where Product is or has been used for racing or any other competitive activity, at any point.

ALL WARRANTIES, EXPRESSED OR IMPLIED, INCLUDING WITHOUT LIMITATION ANY WARRANTY OF MERCHANTABILITY OR FITNESS FOR A PARTICULAR PURPOSE ARE LIMITED IN DURATION TO THE LIFE OF THIS EXPRESS LIMITED WARRANTY. ALL INCIDENTAL, CONSEQUENTIAL, DIRECT, INDIRECT OR OTHER DAMAGES OF ANY KIND ARE EXCLUDED FROM COVERAGE UNDER THIS WARRANTY INCLUDING, BUT NOT LIMITED TO: expense for gasoline, expense for transporting Product to and from Dealer, removal of Product from a boat and reinstallation, mechanic's travel time, in-and-out of water charges, slip or dock fees, trailering or towing, storage, telephone, cell phone, fax or telegram charges, rental of a like or replacement Product or boat during warranty services or down time, taxi, travel, lodging, loss of or damage to personal property, inconvenience, cost of insurance coverage, loan payments, loss of time, income, revenue, profits, enjoyment or use of Product.

SOME JURISDICTIONS DO NOT ALLOW FOR THE DISCLAIMERS, LIMITATIONS OF INCIDENTAL OR CONSEQUENTIAL DAMAGES, OR OTHER EXCLUSIONS IDENTIFIED ABOVE. AS A RESULT, THEY MAY NOT APPLY TO YOU. THIS WARRANTY GIVES YOU SPECIFIC RIGHTS, AND YOU MAY ALSO HAVE OTHER LEGAL RIGHTS THAT MAY VARY FROM JURISDICTION TO JURISDICTION.

Purchaser must bring the Product, including any defective part therein, and proof of purchase of the Product (original bill of sale) to Dealer promptly after the appearance of the defect and, in any event, within the warranty period. Purchaser must sign the repair/work order prior to repair to validate warranty coverage and must provide BRP/Dealer with a reasonable opportunity to repair/replace the defective part. All replaced parts become the property of BRP.

BRP's obligations under this warranty are limited to, at its sole discretion, repairing or replacing parts of Product found to be defective in material or workmanship, in BRP's reasonable judgment. Repair or replacement of parts will be without charge for parts and labor, at any authorized Dealer. No claim of breach of warranty shall be cause for cancellation or rescission of the sale of Product to Purchaser. BRP reserves the right to improve, modify or change Products without assuming any obligation to modify Products previously manufactured. If warranty service is required outside of the fifty United States or Canada, Purchaser will bear responsibility for any additional charges due to local practices and conditions including, but not limited to, freight, insurance, taxes, license fees, import duties, and any financial charges levied by governments, states, territories and agencies.

No distributor, Dealer or any other person is authorized to make any affirmation, representation or warranty regarding Product other than those contained in this limited warranty and, if made, shall not be enforceable against BRP. BRP reserves the right to modify this warranty at any time, being understood that such modification will not alter the warranty conditions applicable to the Products sold while this warranty is in effect. For assistance, please contact BRP US Inc. Consumer Support, P.O. Box 597, 10101 Science Drive, Sturtevant, WI 53177, 1-847-689-7090 or visit [www.brp.com](http://www.brp.com).

The Limited Warranty applies only to Products purchased as new and unused from a distributor or dealer authorized to distribute Products in the country in which the sale occurred.

Products purchased for commercial use, or used commercially at any time during the warranty period, are warranted for TWELVE (12) CONSECUTIVE MONTHS from the date of purchase. Product is used commercially when it is used in connection with any work or employment that generates income, during any part of the warranty period. Product is also used commercially when, at any point during the warranty period, it is installed on a boat that has commercial tags or is licensed for commercial use.

If warranty service is required outside of the country of original sale, Purchaser bears responsibility for any and all charges due to local practices and conditions that exceed or are in addition to customary charges in the country of sale, such as, but not limited to, freight, insurance, taxes, license fees, import duties, and any financial charges levied by governments, states, territories and agencies.

For assistance, please contact BRP US Inc. Consumer Support, P.O. Box 597, 10101 Science Drive, Sturtevant, WI 53177, 1-847-689-7090, or the affiliate of BRP Inc. where the Product was sold to the retail Purchaser.

No other change to the Limited Warranty shall be made or implied.

\* In Canada, products are distributed and serviced by Bombardier Recreational Products Inc.

® Registered trademark of Bombardier Recreational Products Inc. or its affiliates.

© 2009 BRP US Inc. All rights reserved.

Effective as of July 1, 2009.

# INDEX

## A

Accessory Power Relay Kit 14

## B

Buss Cable, Backbone 18

Buss Cable, Extension 18

## C

Communication Errors and Faults 17

Control Hardware Fault 17

Control Lever 9

Control Lever Friction Adjustment 12

Control Module 18

## E

Emergency Stop Lanyard 6

Engine Identity Numbers 14

Engine Identity Plug 14, 18

Engine Management Module (*EMM*) 10, 11, 15

*Evinrude Diagnostics* Software 11, 15

## F

Failsafe Mode 17

FORWARD Gear 9

Frequently Asked Questions 15

Fuse 13, 16, 18

## I

*ICON* Fault Messages 16, 17

*ICON* Gateway Module 13, 15, 16, 18

*ICON* Network Hub 13, 18

*ICON* Network Specifications and Information 13

*ICON* Remote Control Features 4

*ICON* System Diagram 18

Indicator LED Brightness and Gauge Backlighting 12

## L

Long Term Storage Storage 10

## M

Master Power/Key Switch 7, 15, 18

## N

Network Power Cable 16, 18

NEUTRAL 9

NEUTRAL Indicator LED 7, 9, 10, 15

NEUTRAL Throttle 10

NEUTRAL Throttle Switch 10

NMEA 2000 Network/Gauges 18

Notes 23

## O

Operation 5

## P

Periodic Calibration 15

Product Warranty 20

Protective Covers 13

## R

REVERSE Gear 9

RPM Adjustment 10

RPM Switch 10, 12

RPM Reduction, *ICON* Fault 17

## S

Shift Actuator 18

Shift Actuator Motion Fault 17

Shift Actuator Sensor Fault 17

Shift and Throttle Control 9

Specifications 13

Station Protect 11

Station Select 7

Switch Panel 7, 8, 18

## T

THROTTLE 10

Throttle Actuator 18

Throttle Actuator Motion Fault 17

Throttle Actuator Sensor Fault 17

Throttle Friction 12

Trim and Tilt Switch 11

Troubleshooting 16

## W

Warranty 20

Winterizing Procedure 10



