

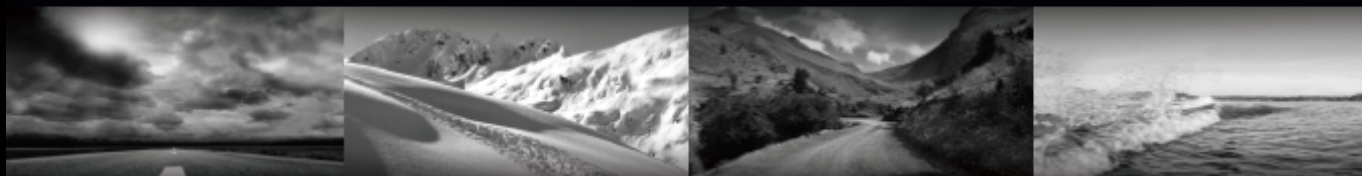

*ski-doo* *LYNX* *SEA-DOO* *ROTAX* *can-am*



# ADVEX HELMET

## USER GUIDE

USER GUIDE

# ADVEX

ENGLISH



# ADVEX Helmet

## CONGRATULATIONS!

You've made an excellent choice with the BRP ADVEX Helmet. The ADVEX helmet is the result of years of research and engineering to create the best product possible for you and your next ride.

With the convenience of a modular helmet coupled with the best features of a full face helmet you are sure to hit the trail in comfort. A perfect helmet for more active trail riders, you can control your air intake, and always ride fog free due to the hot air exhaust. Not only does this helmet have sun visor but it ALSO comes Vibe communication system ready, flashlight ready and removable peak ready.

We hope you love this helmet as much as we loved making it for you!

### **WARNING**

This helmet complies with U.S. Federal Motor Vehicle Safety Standard 218 (DOT FMVSS 218) and/or the United Nations Economic Commission for Europe Regulation 22 (ECE R22.06). This helmet was not designed to be used by a child under 13.

We wish you peace of mind and a safe ride.



# CONTENTS

<b>A. GENERAL</b> .....	<b>4</b>
1. SAFETY INFORMATION	4
<b>B. THE HELMET</b> .....	<b>5</b>
1. ANATOMY OF THE HELMET	5
2. HELMET SIZING	5
3. NECK ROLL	6
4. MICROMETRIC CHIN STRAP	7
5. FACE SHIELD	8
6. SUN VISOR	10
7. FACE SHIELD MECHANISM	11
8. INNER LINER	13
9. VENTILATION SYSTEM	13
<b>C. FIT &amp; USAGE</b> .....	<b>14</b>
1. HOW TO PUT THE HELMET ON	14
2. PROPER FIT	14
3. TAKE THE HELMET OFF	15
<b>D. BEFORE EVERY RIDE</b> .....	<b>16</b>
1. CHECKING THE HELMET	16
2. CHECKING THE CHINSTRAP	16
3. CHECKING THE FACE SHIELD AND SUN VISOR	16
<b>E. OTHER IMPORTANT INFORMATION</b> .....	<b>17</b>
1. MODIFICATIONS / ACCESSORIES	17
<b>F. CARE AND MAINTENANCE</b> .....	<b>18</b>
1. SHELL CLEANING	18
2. INTERIOR CLEANING	18
3. OUTER SURFACE OF THE FACE SHIELD	18
4. SUN VISOR	19
5. HELMET INSPECTION	19
6. HELMET STORAGE	19

<b>G. TROUBLESHOOTING GUIDE</b> .....	<b>20</b>
<b>H. ACCESSORIES AND SPARE PARTS</b> .....	<b>21</b>
1. ACCESSORIES	21
2. REPLACEMENT PARTS	21
<b>I. BRP SERVICE</b> .....	<b>21</b>
1. REPAIR SERVICE	21
2. LIMITED WARRANTY	21
<b>J. HOW TO CONTACT US</b> .....	<b>22</b>

# A. GENERAL

## 1. SAFETY INFORMATION

This helmet is backed by the BRP warranty and a network of authorized dealers and distributors ready to provide the parts, service, or accessories that you may require. Genuine BRP parts should be used for replacement to maintain the warranty, consult an authorized BRP dealer.

Use this User Guide to acquaint yourself with your new helmet and its various functions. Make sure you read and understand the contents of this guide and keep it for future reference. The information and components descriptions contained in this guide are accurate at time of publication. The illustrations in this document may not show the typical construction of the different assemblies or may not reproduce the full detail or exact shape of the parts shown, however, they represent parts which have the same or a similar function.

This guide uses the following safety alert symbol  in conjunction with signal words to indicate a potential personal injury hazard.

<b> WARNING</b>
Indicates a hazardous situation which, if not avoided, could result in death or serious injury.

<b>NOTICE</b>
Address practices not related to personal injury.

Simply reading this guide will not eliminate hazards. The user must understand and follow the instructions. Because of its ongoing commitment to product quality and innovation, BRP reserves the right at any time to discontinue or change specifications, designs, features, or equipment without incurring obligation. If anyone seeks to translate any portion of this guide into any language, this person must ensure that the translation is accurate.

## **WARNING**

Riding a motorized vehicle can be extremely dangerous. This helmet provides limited protection to the head. It complies with U.S. Federal Motor Vehicle Safety Standard 218 (DOT FMVSS 218) and/or the United Nations Economic Commission for Europe Regulation 22 (ECE R22.06).

However, it will not protect the wearer against all possible impacts. Some impacts may exceed this helmet's capability to provide protection and result in serious head, brain, spinal, or other injury including paralysis or death. For maximum protection, the helmet must fit firmly on the head with the chin strap securely fastened.

If your helmet is equipped with a main visor, it must be fully closed. If your helmet is equipped with other components, such as wind deflector, breath deflector, breathing mask, mandible, etc., make sure to install them in proper position to direct exhaled breath away from the main visor. Always wear appropriate protection against frostbite, which may include a balaclava, neck tube, facemask, or combination of these items.

Inspect the helmet before each use following the inspection procedure in the instructions. Replace any part showing wear or damage. Do not alter the helmet or attach any items not recommended by the manufacturer. The helmet is designed to absorb shock by partial destruction of the shell and it should not be visible. Destroy and replace helmet if subjected to a severe blow even if it appears undamaged.

The helmet shell, liner and other components may be damaged and rendered ineffective by petroleum products, cleaning agents, paint, adhesives, etc., without the damage being visible. Use only warm mild soapy water to clean the helmet.

Follow all warnings and instructions provided with this helmet. For replacement instructions, contact BRP. Failure to follow all warnings and instructions can result in serious personal injury or death.

## B. THE HELMET

### 1. ANATOMY OF THE HELMET

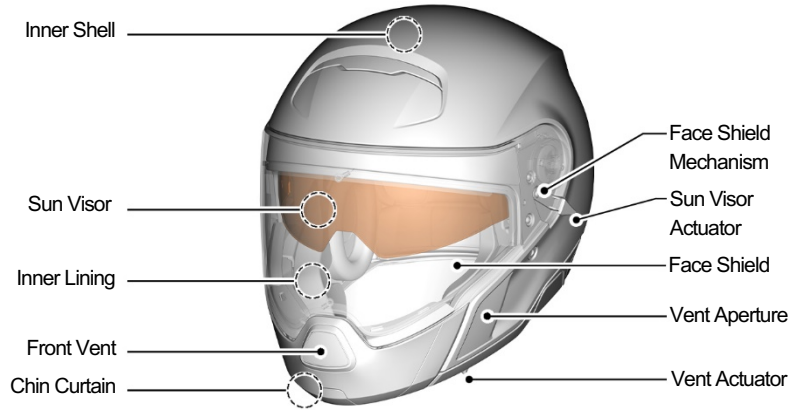

### 2. HELMET SIZING

Helmet size		XS	S	M	L	XL	2XL	3XL
Shell size		S			L			
Head size	mm	53 - 54	55 - 56	57 - 58	59 - 60	61 - 62	63 - 64	65 - 66
	Inches	20 7/8 - 21 1/4	21 5/8 - 22	22 3/8 - 22 3/4	23 1/8 - 23 5/8	24 - 24 3/8	24 3/4 - 25 1/8	25 1/2 - 25 7/8

## B. THE HELMET

### 3. NECK ROLL

The neck roll reduces air intrusion and unpleasant effect of the wind created when you ride by flowing into the helmet. This feature allows to also reduce the riding noises (such as wind, motor, track...).

The fit at the bottom of the helmet is extremely important to make the helmet as quiet as possible.

### REMOVING THE NECK ROLL

1. The neck roll is attached on the chin portion by 4 “arrow snaps”.



2. To remove the neck roll, take one side of the neck roll pull gently upward to disengage the plastic arrow snap.

3. The neck roll is also attached to the neck portion by 3 “snaps” on each side. Pull gently on the neck portion, toward the center of the helmet.



4. Slide out the neck roll from the rear neck portion. To fully remove the protective collar, pull gently on the rear neck portion, toward the center of the helmet.



## B. THE HELMET

### 3. NECK ROLL

#### INSTALLING THE NECK ROLL

1. Insert the 4 “arrow snaps” of the neck roll into their specific housing on the chin portion.



2. Press one by one on the plastic arrow snap to be sure each one is engaged in the chin plastic strip housing as shown.

3. Slide the neck roll in the rear neck portion.



4. Align each of the 6 “snaps” with the triangle on the trim and press one by one to be sure each one is engaged in the plastic housing.



#### **⚠️WARNING**

Do not carry or hold the helmet by the neck roll. The neck roll may come off, causing the helmet to drop.

### 4. MICROMETRIC CHIN STRAP

The retention system of the ADVEX helmet comes with a ratchet fastener. This locking system is easy to use and enables you to adjust the chinstrap perfectly to your head every time you put the helmet on.

#### ADJUSTING THE CHIN STRAP

The length of the chinstrap is adjusted by increasing or reducing the length of strap pulled through the metal buckles. Adjust the length of the chinstrap so that it fits firmly but comfortably under your chin and fix the end of the strap using the retaining loop with comfort pad.

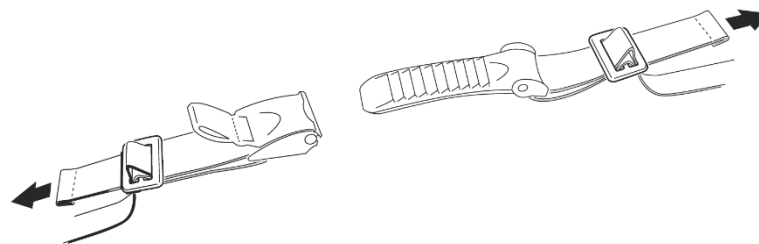

#### **⚠️WARNING**

When adjusting the strap, make sure that the helmet cannot be pulled off in a forward direction with the chinstrap closed.

#### **⚠️WARNING**

Check the adjustment of the chinstrap length at regular intervals.



## B. THE HELMET

### 4. MICROMETRIC CHIN STRAP

#### OPENING AND CLOSING

To close the chinstrap fastener, slide the ratchet tongue step by step into the locking buckle. If you find that the chinstrap fits too loosely around your chin, slide the ratchet tongue one step further into the locking buckle.

When adjusting the chinstrap, make sure that it rests firmly but not uncomfortably around your chin. To open the chinstrap, pull the red ribbon on the ratchet fastener upwards to release the locking buckle. Then pull the ratchet tongue out of the locking buckle.

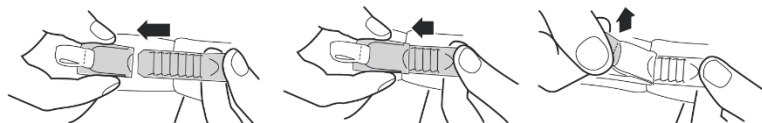

#### **⚠WARNING**

Never ride without making sure that the chinstrap is correctly fastened and adjusted and properly positioned. If the chinstrap is not correctly adjusted or fastened, the helmet could be displaced in the event of an accident.

#### **⚠WARNING**

Closing the comfort pad of the chinstrap alone will not provide adequate protection. The chinstrap must always be fully fastened.

#### **⚠WARNING**

Never open the chinstrap while riding.

### 5. FACE SHIELD

#### **⚠WARNING**

The FMVSS 218 (DOT) standard currently applicable in Canada and USA, allows you to use this face shield in night conditions.

Changing the face shield is easy to do without tools. To replace the face shield, it is helpful to place the helmet on a flat surface on soft cloth or on your lap while seated.

#### REMOVING THE FACE SHIELD

1. If helmet is equipped with a peak. Unlock the peak button by removing the central part.

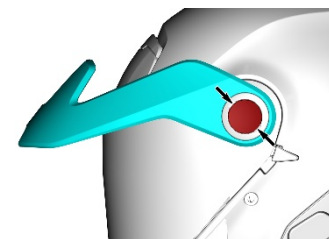

2. If the helmet is equipped with a peak, remove the peak screw by turning the external part a quarter turn counterclockwise.

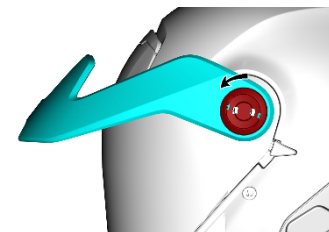

3. If helmet is equipped with a peak. Pull perpendicularly on the side of the peak as shown.



4. If helmet is equipped with a peak. Repeat steps 1 - 3 for the other side.

## B. THE HELMET

### 5. FACE SHIELD

5. Move the face shield into the uppermost locked position.

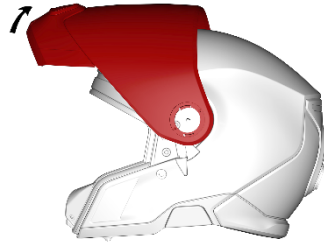

6. On one side, pull the lever of the face shield mechanism downward to release the lower tab of the face shield.

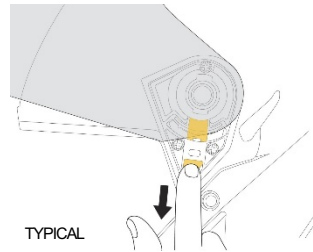

7. Move the lower portion of the face shield pivots upwards until the lower tab is released from the face shield mechanism.

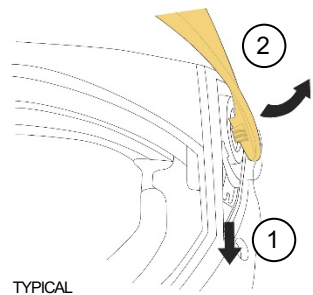

8. Then, pull the face shield downward to release the upper tab from the face shield mechanism.

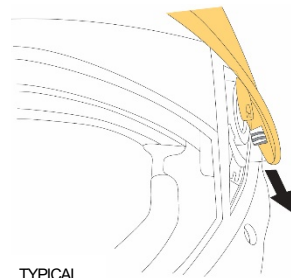

9. Repeat steps 5 – 8 for the other side.

### INSTALLING THE FACE SHIELD

1. Insert the upper tab of the face shield into the specific location on the face shield mechanism.

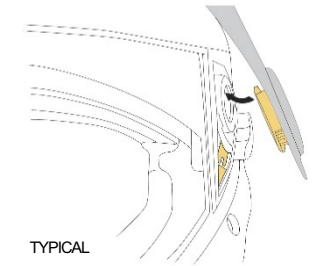

2. Once the tab is in position, pull the lever of the face shield mechanism downwards and slightly push the lower portion of the face shield to set the lower tab back in position.

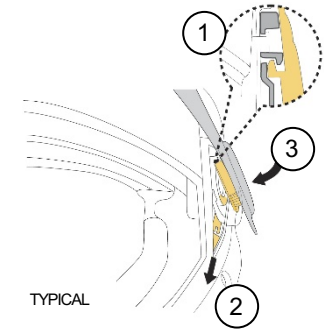

3. Then, release the lever. Make sure the spring pushes it back to the up position and check if the visor is correctly held in place.

4. Repeat steps 1 - 3 for the other side.

For the other side, note that the face shield will be slightly tilted. Make sure the lower tab of the face shield and the recess are perfectly aligned.

## B. THE HELMET

### 5. FACE SHIELD

5. Once both sides are in position, press the face shield pivots gently towards the helmet with a simultaneous closing movement to ensure proper latching.

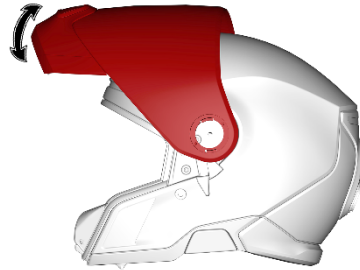

6. Make sure that the face shield mechanism is functioning properly by closing and opening the face shield to its maximum extent.

### 6. SUN VISOR

#### OPERATION

The sun visor is operated by the lever positioned on the left side of the helmet, which makes it easy to use even when wearing thick gloves.

Moving the lever back lowers the sun visor, moving it to the front retracts the sun visor inside the inner helmet shell and locks it in position.

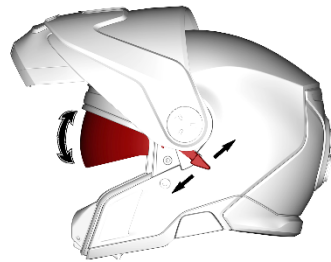

### REMOVING THE SUN VISOR

1. Turn the helmet face shield to the open position.



2. Pivot the sun visor in the lower position.

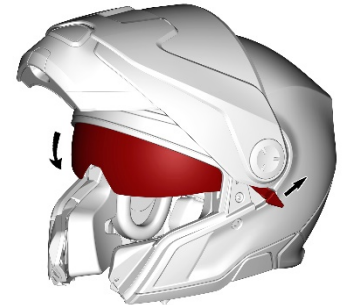

3. Pull the sun visor downward until you see the upper edge.

4. Hold your helmet in position and pull the sun visor on the right side, toward the outside of the helmet.

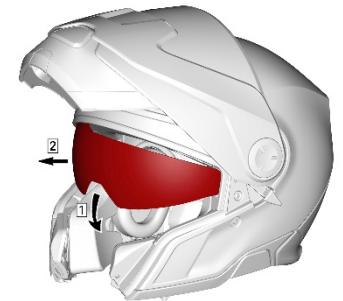

5. Repeat steps 3 - 4 for the other side.

The sun visor lever should remain in the same position while you install the visor.

## B. THE HELMET

### 6. SUN VISOR

#### INSTALLING THE SUN VISOR

1. Make sure the sun visor mechanism is in low position. (Sun visor lever back)

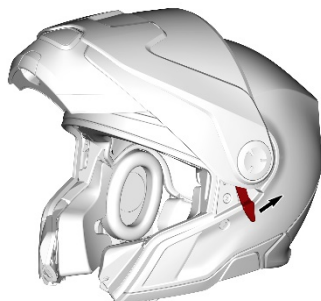

2. Insert the sun visor between helmet inner and outer shell and fit it on to the locating pegs on both sides.

Then, press firmly towards the inside of the helmet until the hook's inner insert is completely inserted.

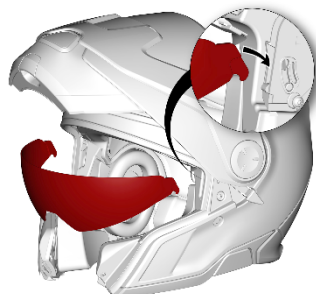

3. Check that the sun visor mechanism is functioning correctly.

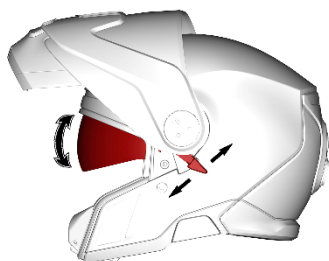

### 7. FACE SHIELD MECHANISM

#### REMOVING / REPLACING THE FACE SHIELD MECHANISM

1. Remove the face shield as described in the "5. FACE SHIELD" section of this manual.

2. Use a Phillips #1 screwdriver to remove the three screws.

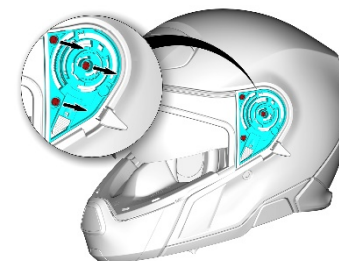

3. Grab the visor mechanism and lift it gently.

7. Repeat steps 2 – 4 for the other side.

8. Put back the face shield as described in the "5. FACE SHIELD" section of this manual.

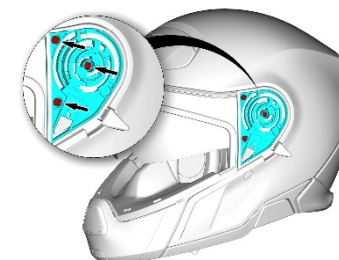

## B. THE HELMET

### 8. INNER LINER

The replaceable inner lining of the ADVEX helmet is washable and ensures both an excellent fit and improved ventilation of the helmet.

The dual-density cheek pads have a specific 3D shape to ensure that the helmet fits comfortably around the cheeks, and the headliner provides an optimal fit all around the head.

All interior fittings are made entirely of skin-friendly material. The material used for the cheek pads and head liner has been treated with an antimicrobial treatment.

When removing the lining, the cheek pads must first be detached before taking out the headliner pad. When fitting the lining, remember to insert the headband pad before the cheek pads.

#### PAD SIZES

Helmet size	XS	S	M	L	XL	2XL	3XL	
Cheek pad thickness	35 mm	30 mm	25 mm	35 mm	35 mm	30 mm	20 mm	
Head liner thickness	Top	16 mm	16 mm	16 mm	16 mm	12 mm	12 mm	12 mm
	Crown	18 mm	16 mm	16 mm	18 mm	8 mm	6 mm	6 mm

#### REMOVING THE CHEEK LINER

To remove the cheek liners, refer to the B.3 section of this guide. The cheek liners are combined to the neck roll for better comfort.

#### REMOVING THE HEAD LINER

1. First, remove the rear portion of the head liner. The head liner is attached to the inner shell with 2 snaps (on each side of the neck) and a frontal portion, with 3 plastic strips.



2. Then you can remove the frontal portion by pulling the 3 snaps. They can be removed by pulling them out carefully.



For the frontal portion, start to pull from one side of the plastic strip.

## B. THE HELMET

### 8. INNER LINER

#### INSTALLING THE HEAD LINER

1. Insert the frontal plastic strip under the notches of the other plastic strip attached to the inner shell.



2. Next, position the head liner inside the helmet.

3. Then, fasten the 2 snaps on the neck portion.



#### ⚠ WARNING

Never ride when parts of the inner lining have been removed.

#### NOTICE

To avoid damage to the inner lining and inner shell, do not hang the helmet over the mirrors or handlebar grips.

### 9. VENTILATION SYSTEM

The ADVEX helmet has a two-way adjustable ventilation system. As needed, you can modulate the air flow:

1. The front vent is adjustable in 2 positions. When the sliding button is in the highest position, the vent is closed. When the sliding button is lowered, it switches to fully open.

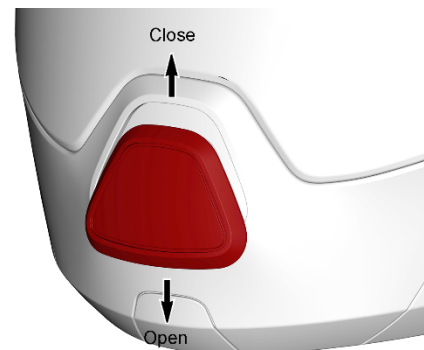

2. **OPEN:** The lower vents are adjustable in 3 positions. When placing both sliding buttons on the «≡» position, this indicates that the air circulates freely.

3. **CLOSED:** When placing both sliding buttons on the «☒» position, this indicates that the air does not circulate.

4. **MIDDLE:** When placing both sliding buttons in the middle position, this indicates that the lower vents are 50% open.

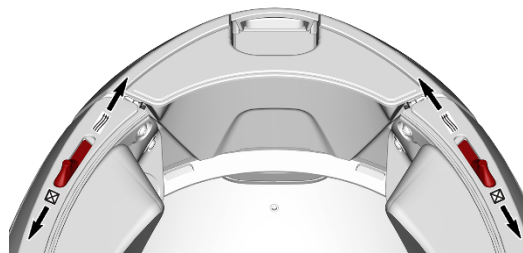



## B. THE HELMET

### 9. VENTILATION SYSTEM

In all cases, it allows you to increase or reduce the air flow to reach the desired level of comfort.

Note: The vehicle speed, the windshield, or the head rotation can affect the air flow inside the helmet.

## C. FIT & USAGE

### 1. HOW TO PUT THE HELMET ON

1. Make sure the sun visor is retracted into the helmet shell.
2. Turn the helmet face shield to the open position.
3. Open the chinstrap and chinstrap comfort pad.
4. Grasp both chin straps and pull them apart.
5. It will now be easy to put the helmet on.
6. Close and fasten the chinstrap.
7. Make sure the chinstrap passes under the chin and fits snugly.
8. Close the visor and chin.
9. Check that the helmet face shield is securely locked by pushing it up from below.

### 2. PROPER FIT

#### **WARNING**

Wearing the wrong helmet size can increase the risk of serious injury or death in an accident. A helmet that is too large for your head may be dislodged or knocked off in an accident.

To select the right helmet size for your head, follow the steps:

#### 1. TRY ON THE HELMET

Grasp both chin straps to pull the helmet completely onto your head, ensuring that the top of your head is in contact with the top of the helmet interior. Try the helmet with all the protection you plan to use (balaclava, neck tube, etc.)

#### 2. CHECK FOR A PROPER FIT

To make sure that your helmet is the right size, check that:

- The helmet inner lining fits snugly around your head.
- The top pad presses firmly on your head.
- The cheek pads contact your cheeks.
- There is no space around your brow under the inner lining. Test this by trying to insert your fingers. If the helmet does not fit snugly, try on a smaller size.

This step might take several trials before finding the perfect adjustment.

#### 3. CHECK YOUR FIELD OF VISION

Some helmets may obstruct or block your vision when looking left, right, up, or down.

#### **WARNING**

Always make sure you can see well enough to safely operate your vehicle.

## C. FIT & USAGE

### 2. PROPER FIT

#### 4. TEST THE HELMET FIT

Place your hands on each side of the helmet. While holding your head as motionless as possible, try rotating your helmet from left to right then up and down. You should feel the helmet move the skin on your head and face as you try to move the helmet.

If it is not the case or if you can feel the helmet padding sliding on your head, it is too big. If the helmet is constricting or painful, it is too small.



#### 5. FASTEN THE CHIN STRAP

Tight it under your jaw until it remains no slack in the strap, and the strap must be tight up against your jaw.

#### 6. TEST THE CHIN STRAP FIT

- Put your hands on the back of the helmet and try to push the helmet off by rotating it forward.
- Put your hands on the front of the helmet above your forehead (or on the chin guard) and try to push.
- If helmet comes off, try another size or model.

Repeat steps 1 through 6 until you find a helmet that fits your head snugly and securely.

### 3. TAKE THE HELMET OFF

1. Make sure the sun visor is retracted.
2. Turn the helmet face shield to the open position.
3. Open the chinstrap and chinstrap comfort pad.
4. Grasp both chin straps and pull them apart.
5. The helmet can now be removed easily.

To avoid scratching any objects you might place the helmet on, we recommend closing the chin-strap after you have taken the helmet off.



## D. BEFORE EVERY RIDE

### 1. CHECKING THE HELMET

Regularly inspect your helmet for damage. Small superficial scratches will not impair the protective function of your helmet.

#### **WARNING**

In the case of more serious damage (cracks, dents, flaking and cracking paint, etc.), the helmet should no longer be used.

### 2. CHECKING THE CHINSTRAP

1. Check that the chinstrap passes under your chin.

2. Slip your index finger under the chinstrap and pull.

If the chinstrap is loose under the chin, it is too long and needs to be tightened. If the chinstrap loosens when you pull it, it is not properly fastened. Undo the chinstrap completely and try fastening it again. Repeat the test.

3. If you are unable to fasten the chinstrap so that it fits firmly against the chin, check that your helmet is still the right size for you.

Repeat the test after each adjustment.

#### **WARNING**

Never ride with the chinstrap unfastened or incorrectly adjusted. The chinstrap should fit correctly and should not become loose when pulled. The fastener is not correctly closed if the chinstrap becomes loose when pulled.

### 3. CHECKING THE FACE SHIELD AND SUN VISOR

The protective film used during shipping should be removed before use.

Before every ride, check that the mechanisms of the face shield and sun visor are working properly and that the face shield and sun visor will provide sufficiently clear visibility. Any dirt should be removed before riding.

Check the face shield and sun visor for physical damage and cracks. A badly scratched face shield will considerably impair your vision and should be replaced before setting off on a journey.

#### **WARNING**

Never use tinted face shield or sun visor in conditions of poor visibility, when riding at night or in a tunnel.

#### **WARNING**

A scratched and/or dirty face shield will seriously impair visibility. For your own safety, replace it or clean it immediately.

#### **WARNING**

Make sure the face shield and sun visor are always in good condition. A damaged face shield is not suitable for riding and needs to be replaced.

#### **WARNING**

Stop riding if visibility is poor.

## E. OTHER IMPORTANT INFORMATION

### 1. MODIFICATIONS / ACCESSORIES

#### WARNING

Original components (in particular on the outer shell, inner shell and restraint system) should not be altered or removed.

Remember that installing unapproved accessories or doing any helmet modification may reduce the protective effect, renders the certification, all warranty and insurance claims invalid.

Use only original parts, replacement parts and accessories that BRP has expressly approved for your helmet!

Modifying your helmet may reduce its ability to protect you and increase your risk of serious injury or death in an accident.

Modifications include the following:

- Drilling holes
- Cutting shell, strap or shock absorbing liner
- Pressing shock absorbing liner
- Modifying the retention system, including adding a chin cup
- Removing parts
- Painting
- Using adhesives
- Installing unapproved accessories

## F. CARE AND MAINTENANCE

### WARNING

Never use petroleum-based chemicals, solvents, gasoline, cleaning agents or adhesives to clean the shell, liners or visors of your helmet. Your helmet shell, liner and visors may be seriously damaged by the use of such products and the full safety function of the helmet can then no longer be guaranteed.

### 1. SHELL CLEANING

To clean the helmet shell, you can use water, soap or one of the commonly available motorcycle shampoos, cleaners, polishes, plastic cleaners or cleaning fluids.

Using water and soap is usually sufficient. Make sure when using the other cleaning materials that these do not come into contact with the face shield, since they can cause damage to the visor and its coating.

### 2. INTERIOR CLEANING

The inner lining of the ADVEX helmet can be removed completely.

The head and cheek pads can be washed by hand using a mild soap solution (e.g. with highly diluted standard mild detergent) at a maximum temperature of 30 °C.

Hand washing is recommended, but machine washing is also permitted. Use the "delicate" cycle to prevent the agitator from damaging the sweat-wicking material covering the liner parts. Allow the lining to dry at room temperature and with good ventilation.

### WARNING

Do not place lining parts in the dryer: Excess heat may damage the foam and coverings.

### 3. OUTER SURFACE OF THE FACE SHIELD

The helmet's shields are specially treated on both sides with an ANTI-FOG or ANTI-SCRATCH coating.

Always use warm soapy water to clean the shields

Always use a soft clean cloth to wipe the shields and avoid scratching the surface.

Never use petroleum based chemicals, solvent, gasoline, cleaning agent or adhesives to clean the shields

### WARNING

Do not use any cleaning agents.

## F. CARE AND MAINTENANCE

### 4. SUN VISOR

#### 4.1 CLEANING THE SUN VISOR

The sun visor should only be cleaned with a soft and, if necessary, slightly damp cloth (we recommend a microfiber cloth).

Only use tepid water (< 20 °C) for cleaning. Never on any account clean the face shield or sun visor with petrol, solvent, a window or glass cleaner or other cleaning agents containing alcohol.

The face shield should not be soaked in water even if it is very dirty on the outside, as this will severely reduce the surface hardness and thus the durability of the anti-fog/anti-scratch coating.

Never attach labels, adhesive tape or stickers to the face shield or sun visor.

Stubborn dirt on the outer surface of the face shield (e.g. dried-on insect remains) can be easily removed by covering the closed visor with a moist or wet cloth and allowing the dirt to soften for around 30 minutes to 1 hour.

### 5. HELMET INSPECTION

Check for helmet damages. If your helmet is damaged or cracked, stop using it immediately and replace it.

Check for worn or damaged parts. Plastic components may wear out over time. If you find worn or damaged parts, replace them or purchase a new helmet. See "Replacement parts" for information on parts replacement.

#### **WARNING**

To reduce the risk of serious injury or death, always inspect your helmet before each ride.

The helmet should be replaced after 3 to 5 years after the date of purchase, depending on use and care. Although the outer shell is in principle capable of a longer service life, the occurrence of material fatigue and wear to other components, as well as the overall action of the helmet and the unknown conditions in which the helmet has been used, make it advisable for your own safety to replace the helmet after this period of use.

Excessive heat (e.g. exhaust heat) can cause damage to the helmet esthetics, the inner shell of the helmet and the interior lining.

### 6. HELMET STORAGE

- Store helmet in a cool and dry place;
- Keep helmet away from pets and other animals;
- Keep helmet away from heat more than 50°C (122°F) and do not set on or near hot surfaces;
- Store helmet in a helmet bag.

#### **WARNING**

Improperly stored helmet can become damaged.

## G. TROUBLESHOOTING GUIDE

PROBLEM	ACTION
FOG APPEARING ON THE MAIN VISOR	<ol style="list-style-type: none"><li>1. Make sure the the Pinlock accessory is properly installed and seals against the main visor.</li><li>2. If the problem is still not resolved, go to your authorized BRP dealer for detailed inspection.</li></ol>
SUN VISOR MALFUNCTION	<ol style="list-style-type: none"><li>1. Check if the sun visor is installed and positioned correctly on the helmet.</li><li>2. Check if there are any broken parts. Replace them by new ones if necessary.</li><li>3. If the problem is still not resolved, go to your authorized BRP dealer for detailed inspection.</li></ol>
LIGHT MALFUNCTION (SOLD SEPARATELY)	<ol style="list-style-type: none"><li>1. Open the flashlight.</li><li>2. If the Vibe communication system is installed: make sure it is charged if the voice system is not installed: check the batteries Replace the batteries by new ones if necessary.</li><li>3. Check if the electrical contacts in the batteries socket are damaged or dirty; Clean the electrical contacts or replace your front utility light if necessary.</li><li>4. If the problem is still not resolved, go to your authorized BRP dealer for detailed inspection.</li></ol>

## H. ACCESSORIES AND SPARE PARTS

You will find a summary of all available accessories and spare parts on internet at <http://store.ski-doo.com/>

### WARNING

For safety reasons, all accessories should be approved by BRP for that specific helmet.

### WARNING

Use of replacement parts other than the ones offered by BRP may increase your risk of serious injury or death. Only use parts that are specifically designed to work with this helmet. BRP recommends that all replacement parts shall be installed by a BRP dealer.

### WARNING

Never modify your helmet – It may reduce your helmet's ability to protect you and increase your risk of serious injury or death.

## 1. ACCESSORIES

Original BRP accessories are available at your authorized BRP dealer. To find BRP dealers in your area, use the dealer search on the BRP website: [www.brp.com](http://www.brp.com)

## 2. REPLACEMENT PARTS

Original BRP parts are available at your authorized BRP dealer. To find BRP dealers in your area, use the dealer search on the BRP website: [www.brp.com](http://www.brp.com)

**Note:** For more information on available replacement parts, please visit our website at the following address: <http://store.ski-doo.com/>

## I. BRP SERVICE

### 1. REPAIR SERVICE

The ADVEX helmet is a BRP quality product that has been designed and manufactured using the latest development and production methods. If a repair to your helmet is necessary, please consult your authorized BRP dealer or distributor.

Upon receipt of a claim, BRP may examine the item and/or delay completion of the claim until the analysis is completed. Even where a clear description of the original fault has been provided, if BRP discover further defaults during the repair, BRP may rectify these without a specific order if this is necessary to restore the correct functioning of the helmet.

### 2. LIMITED WARRANTY

Buying your helmet at an authorized BRP dealer provides a limited warranty for purchased equipment on manufacturing defects. The limited warranty period is 4 years from the purchasing date. Should you have a reason to complain, please contact your authorized BRP dealer. BRP ask that you provide a precise description of the claim as well as a copy of your receipt.

## **J. HOW TO CONTACT US**

### **North America**

565 de la Montagne Street  
Valcourt (Québec) J0E 2L0  
Canada

Sturtevant, Wisconsin, U.S.A.  
10101 Science Drive  
Sturtevant, Wisconsin  
53177  
U.S.A.

Sa De Cv, Av. Ferrocarril 202  
Parque Ind. Querétaro, Lote2-B  
76220  
Santa Rosa Jáuregui, Qro.  
Mexico

### **Oceania**

6 Lord Street  
Lakes Business Park  
Botany, NSW 2019  
Australia

### **South America**

Rua James Clerck Maxwell, 230  
TechnoPark Campinas  
SP 13069-380  
Brazil

### **Asia**

15/F Parale Mitsui Building,8  
Higashida-Cho, Kawasaki-ku  
Kawasaki 210-0005  
Japan

Room Dubai, level 12, Platinum  
Tower  
233 Tai Cang Road  
Xintiandi, Lu Wan District  
Shanghai 200

For your nearest authorized BRP dealer or distributor or for more information on BRP products, please visit our web site:

[www.brp.com](http://www.brp.com)

©™ and the BRP logo are trademarks of Bombardier Recreational Products inc. or its affiliates.

© 2023. Bombardier Recreational Products Inc.

BRP\_20230101\_R00EN